

RESOLUTION NO. 4522

A RESOLUTION ACCEPTING THE FOLLOWING DEDICATION DEED:

Grantor

Linda K. Franklin

Purpose

A permanent Dedication Deed described in attached EXHIBIT A and as shown in attached EXHIBIT B.

NOW, THEREFORE, BE IT RESOLVED by the Albany City Council that it does hereby accept this easement.

DATED THIS 10TH DAY OF OCTOBER, 2001.

  
\_\_\_\_\_  
Mayor

ATTEST:

  
\_\_\_\_\_  
City Clerk

DEDICATION DEED  
N-004

KNOW ALL MEN BY THESE PRESENTS, that Linda K. Franklin, hereinafter referred to as the Grantor, does dedicate to the City of Albany for street and utility right-of-way purposes situated in Linn County, State of Oregon, described as follows:

A tract of land as described in the attached description and as shown on Attached EXHIBIT A.

and covenants that the Grantor is the owner of the above described real property free of all encumbrances save and except reservations in patents and easements or record, and will warrant and defend the same against all persons who may lawfully claim the same.

The deed granted herein is in consideration of \$1.00, receipt of which is acknowledged by the Grantor, and in further consideration of the public improvements to be placed upon said property and the benefits grantors may obtain there from. Nothing herein shall reduce or limit grantors obligation to pay any costs or assessments, which may result from the improvements.

IN WITNESS WHEREOF, the Grantors have hereunto affixed their signatures this 29<sup>th</sup> day of May, 2001.

GRANTOR:

GRANTOR:

Linda K. Franklin  
LINDA K. FRANKLIN

\_\_\_\_\_

STATE OF OREGON )  
County of Linn )  
City of Albany )

STATE OF OREGON )  
STATE OF OREGON )  
City of Albany )

The foregoing instrument was acknowledged Before me this 29<sup>th</sup>-day of May, 2001 by his voluntary act and deed.

The foregoing instrument was acknowledged Before me this \_\_\_-day of \_\_\_\_\_, \_\_\_\_\_ by his voluntary act and deed.

Matthew A. Ruettgers  
Notary Public for Oregon  
My Commission Expires: 2-28-05

\_\_\_\_\_  
Notary Public for Oregon  
My Commission Expires: \_\_\_\_\_

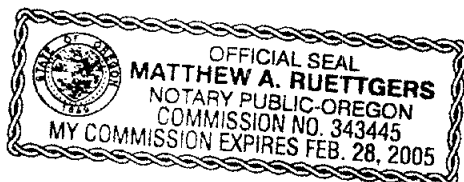

Return to: City of Albany - Recorder  
P.O. Box 490, Albany, OR 97321

N-004

CITY OF ALBANY

STATE OF OREGON )  
County of Linn )  
City of Albany )

I, Steve Bryant as City Manager of the  
City of Albany, Oregon, pursuant to Resolution  
Number 4522, do hereby accept on  
Behalf of the City of Albany, the above  
Instrument pursuant to the terms thereof this  
11 Day of October,  
2001.

  
\_\_\_\_\_  
City Manager

ATTEST:

  
\_\_\_\_\_  
City Recorder Clerk



DEDICATION DEED TO THE CITY OF ALBANY

N-004

A portion of that certain tract of land described in Vol 592 Page 966 of Linn County Deed of Records, described as follows:

Beginning at the southeast corner of said tract, thence a distance of 6 feet along its east line to a point; thence to a point lying on the south line of said tract and being 5 feet from its southeast corner; thence along the south boundary line to the point of beginning, All lying in the SW ¼ of Section 17, Township 11 South, Range 03 West, Willamette Meridian, Linn County, Oregon and containing 15 square feet, more or less.

For reference purposes, this tract of land can be seen on tax assessors map 113W17CA tax lot 2200, and on the attached exhibit 'A'.

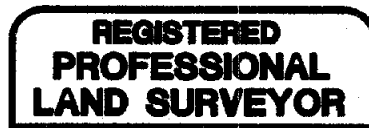

*Leonard L. Smith*



RENEWAL 6/30/2002

**EXHIBIT 'A'**  
N-004

**STREET ADDRESS 3312**  
**TAX MAP 113W17CA**  
**TAX LOT 2200**



SCALE: NTS

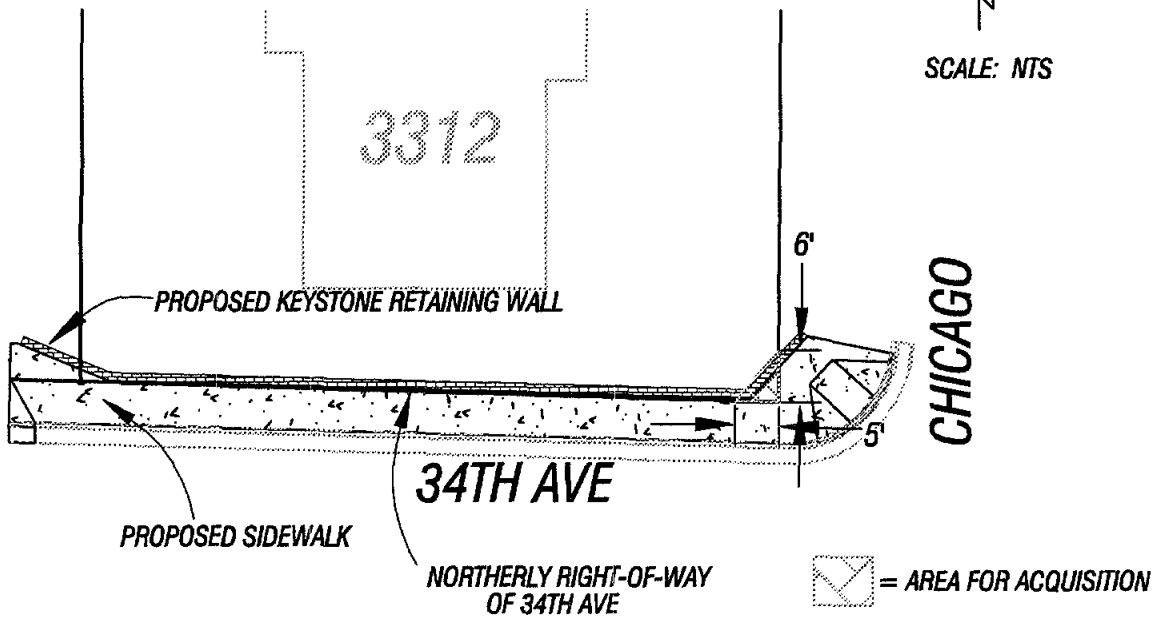

<p>REGISTERED PROFESSIONAL LAND SURVEYOR</p> <p><i>Leonard L. Smith</i></p> <p>OREGON SEPTEMBER 23, 1977 LEONARD L. SMITH 1329</p> <p>RENEWAL 6/30/2002</p>	<p><b>PacWest</b> Engineering</p> <p>1530 NINTH AVE. SE TEL 1-888-926-7634 ALBANY, OR. 97321 FAX 541-926-7539</p>		Project: 99-051
	Client: CITY OF ALBANY		Drawing No.: ROWTAKES/BASE
	Drawn: J. BLAINE	Field: D. BECKER	Date: 02-22-01
	Calc'd: J. BLAINE	Checked: L. SMITH	Scale: NTS
		Page Of 2 2	

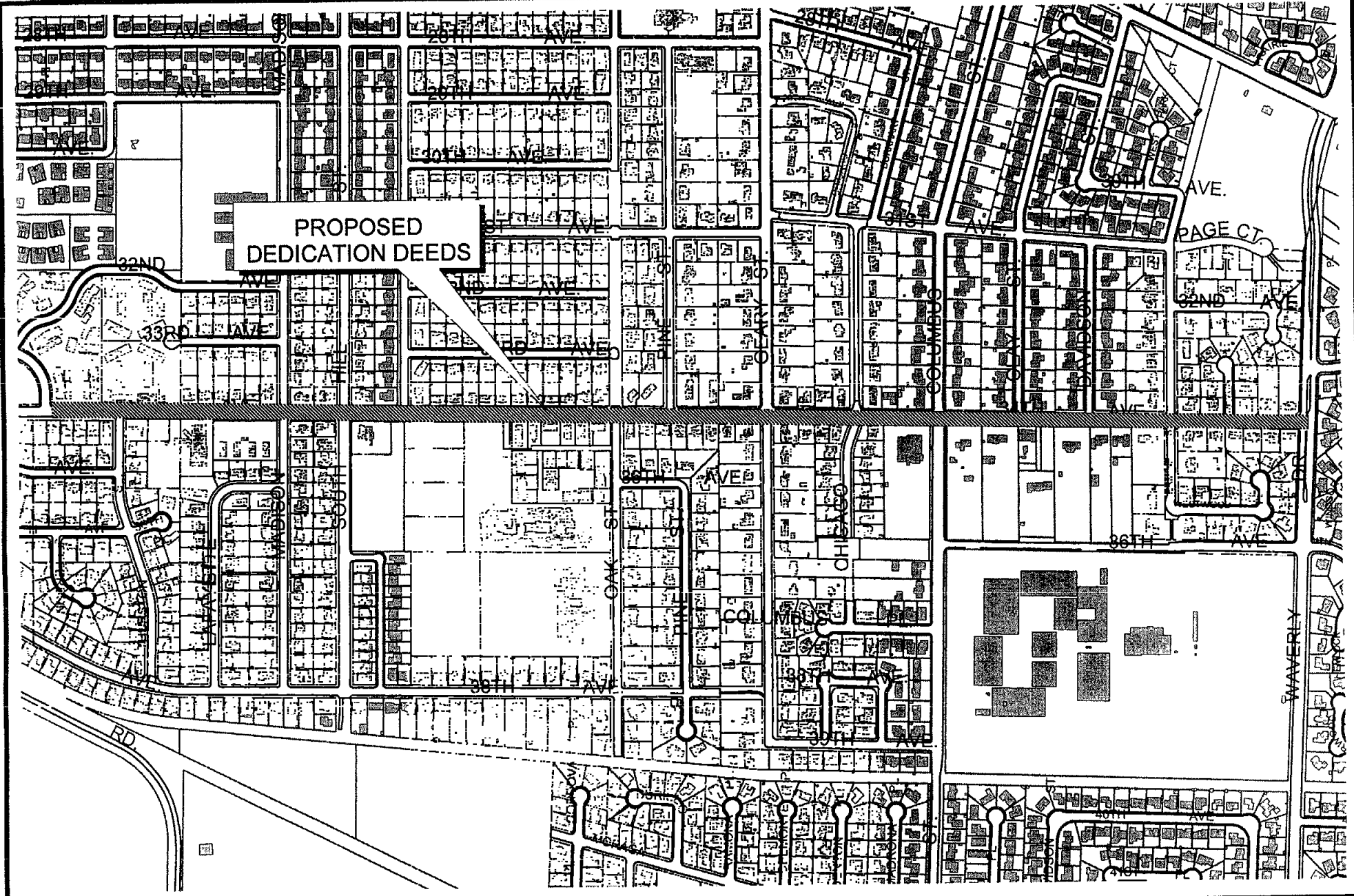

VOL 1226 PAGE 649

**VICINITY MAP**

**ST-01-01 34th Ave, Rehabilitation, Phase II**



Dedication Deeds

Engineering - Angie

Mark Shepard

Sep 28, 2001

600 0 600 Feet

The City of Albany's Infrastructure records, drawings and other documents have been gathered over many decades using differing standards for quality control, documentation and verification. All the information provided represents current information in a readily available format. While the information provided is generally believed to be accurate, occasionally this information proves to be incorrect and thus its accuracy is not warranted. Prior to making any property purchase or other investments based in full or in part upon the information provided, it is specifically advised that you independently field verify the information contained within our records.



angles g \engineer\g\vicinity map apr

46

STATE OF OREGON  
County of Linn

I hereby certify that the attached  
was received and duly recorded  
by me in Linn County records.

STEVE DRUCKENMILLER  
Linn County Clerk

By SR, Deputy

M  
E  
S  
A  
O

2001 OCT 22 P 1: 57

MF 1226

PAGE 645

Resolution No. 4522

Recorded Document Recorder File 3919