

2735
2735
2735
2735
2735
2735
2735

AN ORDINANCE TO DETERMINE THE ASSESSMENTS AGAINST THE PROPERTY SPECIFICALLY BENEFITED BY THE SOUTH RESIDENTIAL STORM SEWER TRUNK AND LATERAL IMPROVEMENTS.

Recitals:

1. The South Residential Storm Sewer Districts, as referred to in this ordinance and previous resolutions and ordinances, are those areas outlined on the accompanying map marked Exhibit A.
2. Preliminary resolutions and ordinances prescribing the manner and extent of the improvements are set forth in Resolutions 399 and 407 and in Ordinance No. 2723.
3. The assessments set forth in the following ordinance are based upon the report and recommendation of the City Engineer in compliance with Ordinance No. 2723.

THE PEOPLE OF THE CITY OF ALBANY DO ORDAIN AS FOLLOWS:

Section 1. The total cost of the sewer improvements in the South Residential Storm Sewer Trunk and Lateral Districts is hereby determined to be \$158,526.23. The following represents a breakdown of the trunk and lateral costs to be assessed against the property particularly benefited thereby:

Trunk System

Construction Costs	\$94,827.49	
15% Engineer, Legal & Administrative Costs	<u>14,224.12</u>	\$109,051.61

Lateral System

Construction Costs	\$43,021.41	
15% Engineer, Legal & Administrative Costs	<u>6,453.21</u>	49,474.62
		<u>\$158,526.23</u>

Section 2: The proportionate share to be assessed against the property specifically benefited thereby is hereby determined to be on the basis of \$0.012950223 per Square foot for the Trunk System and \$0.014175161 per square foot for the Lateral System, and the assessment shall be in the amount set forth after the description of the particular property.

<u>Name of Person on Assessment Roll</u>	<u>Description of Property</u>	<u>Area Assessed</u>	<u>Amount of Assessment</u>
Leroy W. Govro 2225 S. Main Street	W. 77.47' of W. 200' Lot 1 Morningside Tract	15,494	\$ 200.65
Harold W. & Phyllis A. Agnew 2810 Park Terrace	S. 76' of W. 200' Lot 1 Morningside Tract	15,200	196.84
Robert F. & LaDonna Louise Daly 2430 Denver Place	E. 50' Lot 1 Morningside Tract	7,673.5	99.37
Robert F. & LaDonna Louise Daly	W. 10' of E. 20' Lot 2 Morningside Tract	1,362.2	17.65
Milton B. & Ethel L. Hall P. O. Box 148	W. 120' Lot 2 Morningside Tract	16,358.4	211.84
Verna Miller 1115 E. 23rd Avenue	W. 100' of S. 130' Lot 2 Morningside Tract	13,632	176.54
Robert & Arlene Dahl 1925 Emmette Street	E. 20' Lot 2 Morningside Tract	2,726.4	35.31
Robert & Arlene Dahl	W. 30' Lot 3 Morningside Tract	6,086	88.27
Erman K. & Erma E. Johnston 2210 S. Geary St.	E. 150' Lot 3 Morningside Tract	20,488	264.81
Erman K. & Erma E. Johnston	E. 150' Lot 4 Morningside Tract	23,020.5	298.13
Robert F. & LaDonna Louise Daly 2430 Denver Place	W. 50' Lot 4 Morningside Tract	7,673.5	99.37
Erman K. & Erma E. Johnston 2210 S. Geary St.	Lot 5 Morningside Tract	40,606.55	525.86
Frank Sloan & Virginia Dannals 1110 E. 23rd Ave.	W. 95' Lot 6 Morningside Tract	12,712.9	164.64

<u>Name of Person on Assessment Roll</u>	<u>Description of Property</u>	<u>Amount of Assessment</u>
Frank E. & Aileen Block 1130 E. 23rd Avenue	E. 25' Lot 6 Morningside Tract	3,345.3 \$ 43.33
Harold & Dorothy Ann Jackson 1120 E. 23rd Ave.	E. 80' of E. 175' Lot 6 Morningside Tract	10,705.6 138.64
Clyde M. & Carolyn Rogers 1115 E. 24th Avenue	E. 75' of W. 135' Lot 7 Morningside Tract	10,036.5 129.97
Gene & Barbara E. Asai 1105 E. 24th Avenue	W. 80' Lot 7 Morningside Tract	10,705.6 138.64
Glenn L. & Ada Lou Galloway 1125 E. 24th Ave.	E. 45' Lot 7 Morningside Tract	6,021.9 77.99
Glenn L. & Ada Lou Galloway	W. 55' Lot 8 Morningside Tract	7,360.1 95.31
Robert W. & LeVada Erner 1135 E. 24th Ave.	W. 95' of E. 135' Lot 8 Morningside Tract	12,712.9 164.64
Forrest D. & Bertha L. Liddle 2340 S. Oak St.	E. 100' Lot 8 Morningside Tract	13,382 173.30
Frank E. & Aileen Block 1130 E. 23rd Ave.	E. 45' Lot 9 Morningside Tract	6,021.9 77.99
Edward A. & Zella Perfect 1140 E. 23rd Ave.	E. 70' of W. 115' Lot 9 Morningside Tract	9,367.4 121.31
William K. & Gracia L. Jordan 169 W. Bodie St. Roseburg, Oregon	W. 70' of E. 135' Lot 9 Morningside Tract	9,367.4 121.31
William T. & Catherine J. Peterson 1160 E. 23rd Ave.	E. 65' Lot 9 Morningside Tract	8,698.3 112.65
Scharpf's Twin Oak Builders Supply Co. 760 E. 2nd Ave.	Lot 10 Morningside Tract	37,481.6 485.39
Robert F. & LaDonna Louise Daly 2430 Denver Avenue	Lot 11 Morningside Tract	26,604.78 344.54
Robert F. & LaDonna Louise Daly	Lot 12 Morningside Tract	28,647.65 370.99
Robert F. & LaDonna Louise Daly	Lot 13 Morningside Tract	28,647.65 370.99
Robert F. & LaDonna Louise Daly	Lot 14 Morningside Tract	31,611.2 409.37
Jack C. & Aletha C. Utterback 2005 E. 5th Ave.	E. 74.83' of S. 68.16, also 7.62' adj. on E. Daly & Kelly Supp. Plat to Hollywood Acres Block 21 Lot 1	5,619.79 72.78
Lyle & Ardyce Houser 220 S. Main Street	Also 7.62' strip adj. on East Lot 2 Block 21 Daly & Kelly Supp. Plat to Hollywood Acres	5,807.23 75.20
Scharpf's Twin Oaks Builders Supply Co. 760 E. 2nd Avenue	Also 7.62' strip adj. on East Lot 3 Block 21 Daly & Kelly Supp. Plat to Hollywood Acres	6,073.06 78.65
Scharpf's Twin Oaks Builders Supply Co.	Ex. S. 1.24', also 7.62' strip adj. on East Lot 4 Block 21 Daly & Kelly Supp. Plat to Hollywood Acres	5,967.41 77.28
Harold W. & Bessie L. Pollock 814 Charnelton St. Eugene, Oregon	S. 22.52' of E. 59.98' also 7.62' strip on E. Lot 5 Block 21 Daly & Kelly Supp. Plat to Hollywood Acres	1,521.00 19.70
Harold W. & Bessie L. Pollock	E. 59.98' also 7.62' strip on East Lot 6 Block 21 Daly & Kelly Supp. Plat to Hollywood Acres	4,818.53 62.40
Harold W. & Bessie L. Pollock	N. 6.20' of E. 59.98' also 7.62' strip on East Lot 7 Block 21 Daly & Kelly Supp. Plat to Hollywood Acres	419.12 5.43

<u>Name of Person on Assessment Roll</u>	<u>Description of Property</u>	<u>Area Assessed</u>	<u>Amount of Assessment</u>
John A. & Margaret E. Boeck 532 W. 7th Ave.	All Ew. n. 6.20' wide 7.62' strip on E. Lot 7 Block 21 Daly & Kelly Supp. Plat to Hollywood Acres	5,544.82	\$ 71.81
John A. & Margaret E. Boeck	Also 7.62' strip on East Lot 8 Block 21 Daly & Kelly Supp. Plat to Hollywood Acres	6,073.06	78.64
John A. & Margaret E. Boeck	Also 7.62' strip on East Lot 9 Block 21 Daly & Kelly Supp. Plat to Hollywood Acres	6,073.06	78.65
Robert F. & LaDona Louise Daly & Orris L. & Jewel A. Bowman 500 W. Harrison St.	Lot 1 So. Add. to Morningside Tract	31,524	408.24
Robert F. & LaDona Louise Daly & Orris L. & Jewel A. Bowman	N. 175' Lot 2 So. Add. to Morning- side Tract	7,583.9	357.21
Norman D. & Elaine N. Ca- hill 2540 S. Main Street	S. 50' Lot 2 So. Add. to Morning- side Tract	7,881.0	102.06
Norman D. & Elaine D. Ca- hill	N. 25' Lot 3 So. Add to Morning- side Tract	3,940.5	51.03
Luella M. Herman 721 N. 17th St. Corvallis, Ore.	S. 175' Lot 3 So. Add. to Morning- side Tract	27,583.5	357.22
Luella M. Herman	N. 5' Lot 4 So. Add. to Morning- side Tract	788.1	10.20
Robert F. & LaDona Louise Daly & Orris L. & Jewel A. Bowman	S. 214.33' Lot 4 So. Add. to Morning- side Tract	33,792.28	437.62
Robert F. & LaDona Louise Daly & Orris L. & Jewel A. Bowman	Lot 5 So. Add. to Morningside Tract	24,044.53	311.62
Robert F. & LaDona Louise Daly & Orris L. & Jewel A. Bowman	Lot 6 So. Add. to Morningside Tract	24,933.91	322.90
Robert F. & LaDona Louise Daly & Orris L. & Jewel A. Bowman	Lot 7 So. Add. to Morningside Tract	30,958.50	400.92
Robert F. & LaDona Louise Daly & Orris L. & Jewel A. Bowman	Lot 8 So. Add. to Morningside Tract	26,794	346.99
Robert F. & LaDona Louise Daly & Orris L. & Jewel A. Bowman	Lot 9 So. Add. to Morningside Tract	30,195	391.03
Robert F. & LaDona Louise Daly & Orris L. & Jewel A. Bowman	Lot 10 So. Add. to Morningside Tract	26,888	348.20
Robert F. & LaDona Louise Daly & Orris L. & Jewel A. Bowman	Lot 11 So. Add. to Morningside Tract	29,000	375.55
Robert F. & LaDona Louise Daly & Orris L. & Jewel A. Bowman	Lot 12 So. Add. to Morningside Tract	29,000	375.55
Robert F. & LaDona Louise Daly & Orris L. & Jewel A. Bowman	Lot 13 So. Add. to Morningside Tract	32,625	422.50
Robert F. & LaDona Louise Daly & Orris L. & Jewel A. Bowman	Lot 14 So. Add. to Morningside Tract	32,625	422.50
Robert F. & LaDona Louise Daly & Orris L. & Jewel A. Bowman	Lot 15 So. Add. to Morningside Tract	36,250	469.45

<u>Name of Person or Assessment Roll</u>	<u>Description of Property</u>	<u>Area Assessed</u>	<u>Amount of Assessment</u>
Robert F. & LeDonna Louise Daly & Orris L. & Jewel A. Bowman 130 W. Harrison St.	Lot 16 No. Add. to Morningside Tract	36,230	\$ 469.45
John A. & Margaret E. Boock 532 W. 7th Avenue	Lot 11 Block 16 Daly & Kelly Supp. to Hollywood Acres	5,670.1	73.43
John A. & Margaret E. Boock	Lot 12 Block 16 Daly & Kelly Supp. to Hollywood Acres	5,670.1	73.43
John A. & Margaret E. Boock	Lot 13 Block 16 Daly & Kelly Supp. to Hollywood Acres	8,745.66	113.26
John A. & Margaret E. Boock	Lot 14 Block 16 Daly & Kelly Supp. to Hollywood Acres	8,745.66	113.26
John A. & Margaret E. Boock	Lot 15 Block 16 Daly & Kelly Supp. to Hollywood Acres	8,745.66	113.26
John A. & Margaret E. Boock	Lot 16 Block 16 Daly & Kelly Supp. to Hollywood Acres	8,745.66	113.26
John A. & Margaret E. Boock	Lot 17 Block 16 Daly & Kelly Supp. to Hollywood Acres	8,745.66	113.26
John A. & Margaret E. Boock	Lot 18 Block 16 Daly & Kelly Supp. to Hollywood Acres	8,745.66	113.26
John A. & Margaret E. Boock	Lot 20 Block 16 Daly & Kelly Supp. to Hollywood Acres	6,941.00	89.89
John A. & Margaret E. Boock	Block 16 (Vacated Street)	4,164.60	53.93
H. L. & Hazel Fair Rt. 2 Box 392	S $\frac{1}{2}$ Block 10 Hollywood Acres	43,560.52	564.12
Charles & Retta Mae Draper 1715 S. Hill Street	N $\frac{1}{2}$ Blk. 10, Ex. the N. 20' of E. 130.95' & N. 166.325' of W. 130.95' Hollywood Acres	19,161.26	248.14
Floyd H. & Shirley R. Goin 2400 S. Hill Street	N. 20' of E. 130.95' & N. 166.325' of W. 130.95' Hollywood Acres Block 10	24,399.26	315.97
Owen & Mary G. Beam 225 W. 2nd Avenue	Block 11 Hollywood Acres	87,121.04	1,128.24
John A. & Margaret E. Boock 532 W. 7th Avenue	Block 12 Hollywood Acres	103,660.02	1,342.42
Owen Beam 225 W. 2nd Ave.	Block 13 Hollywood Acres	227,163.60	2,941.82
Isaid & Jerelee M. Hyde 2755 S. Hill Street	S $\frac{1}{2}$ of Tr. 14 Ex. W. 200' of N. 136.25' Hollywood Acres Block 14	65,874.37	853.09
Jack & Barbara Draper 1715 S. Hill Street	W. 200' of N. 136.25' of S $\frac{1}{2}$ of Tr. 14 Block 14 Hollywood Acres	27,250.00	352.89
Owen Beam 225 W. 2nd Ave.	N $\frac{1}{2}$ Block 14 Hollywood Acres	93,117.05	1,205.89
Owen Beam	Ex. N. 20' Block 15 Hollywood Acres	175,005.84	2,266.36
J. L. Rodgers 341 E. 4th Avenue	Lot 1 Block 1 2nd Add. to Rodgers Acres	7,071	91.57
J. L. Rodgers	Lot 2 Block 1 2nd Add. to Rodgers Acres	7,500	97.13
J. L. Rodgers	Lot 3 Block 1 2nd Add. to Rodgers Acres	7,500	97.13
J. L. Rodgers	Lot 4 Block 1 2nd Add. to Rodgers Acres	7,500	97.12
J. L. Rodgers	Lot 5 Block 1 2nd Add. to Rodgers Acres	7,500	97.13
J. L. Rodgers	Lot 6 Block 1 2nd Add. to Rodgers Acres	7,500	97.13
J. L. Rodgers	Lot 7 Block 1 2nd Add. to Rodgers Acres	7,500	97.12

<u>Name of Person on Assessment Roll</u>	<u>Description of Property</u>	<u>Area Assessed</u>	<u>Amount of Assessment</u>
Jack & Barbara Draper 1715 S. Hill Street	Lot 8 Block 1 2nd Add. to Rodgers Acres	7,500	\$ 97.13
Jack & Barbara Draper	Lot 9 Block 1 2nd Add. to Rodgers Acres	7,500	97.13
Jack & Barbara Draper	Lot 10 Block 1 2nd Add. to Rodgers Acres	7,500	97.12
Jack & Barbara Draper	Lot 11 Block 1 2nd Add. to Rodgers Acres	7,500	97.13
Jack & Barbara Draper	Lot 12 Block 1 2nd Add. to Rodgers Acres	7,109	92.06
Jack & Barbara Draper	Lot 1 Block 2 2nd Add. to Rodgers Acres	8,867.51	114.84
J. L. Rodgers 341 E. 4th Avenue	Lot 2 Block 2 2nd Add. to Rodgers Acres	8,553.69	110.77
Jack & Barbara Draper 1715 S. Hill Street	Lot 3 Block 2 2nd Add. to Rodgers Acres	7,950	102.95
J. L. Rodgers 341 E. 4th Avenue	Lot 4 Block 2 2nd Add. to Rodgers Acres	7,950	102.95
J. L. Rodgers	Lot 5 Block 2 2nd Add. to Rodgers Acres	7,100	91.95
Jack & Barbara Draper 1715 S. Hill Street	Lot 6 Block 2 2nd Add. to Rodgers Acres	7,000	90.65
Jack & Barbara Draper	Lot 7 Block 2 2nd Add. to Rodgers Acres	7,100	91.95
J. L. Rodgers 341 E. 4th Avenue	Lot 1 Block 3 2nd Add. to Rodgers Acres	8,040.56	104.13
J. L. Rodgers	Lot 2 Block 3 2nd Add. to Rodgers Acres	7,726.74	100.06
J. L. Rodgers	Lot 3 Block 3 2nd Add. to Rodgers Acres	7,950	102.95
J. L. Rodgers	Lot 4 Block 3 2nd Add. to Rodgers Acres	7,950	102.95
J. L. Rodgers	Lot 5 Block 3 2nd Add. to Rodgers Acres	7,100	91.95
J. L. Rodgers	Lot 6 Block 3 2nd Add. to Rodgers Acres	7,000	90.65
J. L. Rodgers	Lot 7 Block 3 2nd Add. to Rodgers Acres	7,100	91.95
J. L. Rodgers	Lot 1 Block 4 2nd Add. to Rodgers Acres	6,603.30	85.51
J. L. Rodgers	Lot 2 Block 4 2nd Add. to Rodgers Acres	6,300	81.59
J. L. Rodgers	Lot 3 Block 4 2nd Add. to Rodgers Acres	6,300	81.59
J. L. Rodgers	Lot 4 Block 4 2nd Add. to Rodgers Acres	6,300	81.59
J. L. Rodgers	Lot 5 Block 4 2nd Add. to Rodgers Acres	6,300	81.59
J. L. Rodgers	Lot 6 Block 4 2nd Add. to Rodgers Acres	6,300	81.59
J. L. Rodgers	Lot 7 Block 4 2nd Add. to Rodgers Acres	6,300	81.59
J. L. Rodgers	Lot 8 Block 4 2nd Add. to Rodgers Acres	6,300	81.58
J. L. Rodgers	Lot 9 Block 4 2nd Add. to Rodgers Acres	6,300	81.59

<u>Name of Person on Assessment Roll</u>	<u>Description of Property</u>	<u>Area Assessed</u>	<u>Amount of Assessment</u>
J. L. Rodgers 341 E. 4th Avenue	Lot 10 Block 4 2nd Add. to Rodgers Acres	6,300	\$ 81.59
J. L. Rodgers	Lot 11 Block 4 2nd Add. to Rodgers Acres	6,300	81.58
J. L. Rodgers	Lot 12 Block 4 2nd Add. to Rodgers Acres	6,300	81.59
J. L. Rodgers	Lot 13 Block 4 2nd Add. to Rodgers Acres	6,480	83.92
J. L. Rodgers	Lot 14 Block 4 2nd Add. to Rodgers Acres	6,480	83.92
J. L. Rodgers	Lot 15 Block 4 2nd Add. to Rodgers Acres	6,300	81.59
J. L. Rodgers	Lot 16 Block 4 2nd Add. to Rodgers Acres	6,300	81.58
J. L. Rodgers	Lot 17 Block 4 2nd Add. to Rodgers Acres	6,300	81.59
J. L. Rodgers	Lot 18 Block 4 2nd Add. to Rodgers Acres	6,300	81.58
J. L. Rodgers	Lot 19 Block 4 2nd Add. to Rodgers Acres	6,300	81.59
J. L. Rodgers	Lot 20 Block 4 2nd Add. to Rodgers Acres	6,300	81.58
J. L. Rodgers	Lot 21 Block 4 2nd Add. to Rodgers Acres	6,300	81.59
J. L. Rodgers	Lot 22 Block 4 2nd Add. to Rodgers Acres	6,300	81.58
J. L. Rodgers	Lot 23 Block 4 2nd Add. to Rodgers Acres	6,300	81.59
J. L. Rodgers	Lot 24 Block 4 2nd Add. to Rodgers Acres	6,300	81.59
J. L. Rodgers	Lot 25 Block 4 2nd Add. to Rodgers Acres	6,300	81.59
J. L. Rodgers	Lot 26 Block 4 2nd Add. to Rodgers Acres	6,652.80	86.15
Scharpf's Twin Oak Builders Supply Co. 760 2nd Avenue	Lot 1 Block 5 2nd Add. to Rodgers Acres	7,169	92.84
Scharpf's Twin Oak Builders Supply Co.	Lot 2 Block 5 2nd Add. to Rodgers Acres	7,500	97.13
Scharpf's Twin Oak Builders Supply Co.	Lot 3 Block 5 2nd Add. to Rodgers Acres	7,500	97.13
Scharpf's Twin Oak Builders Supply Co.	Lot 4 Block 5 2nd Add. to Rodgers Acres	7,500	97.12
Scharpf's Twin Oak Builders Supply Co.	Lot 5 Block 5 2nd Add. to Rodgers Acres	7,500	97.13
Jack & Barbara Draper 1715 B. Hill Street	Lot 6 Block 5 2nd Add. to Rodgers Acres	7,500	97.13
Howard L. & Elna J. Maloney Box 546 Healdsburg, Cal.	Lot 7 Block 5 2nd Add. to Rodgers Acres	7,500	97.12
Howard L. & Elna J. Maloney	Lot 8 Block 5 2nd Add. to Rodgers Acres	7,500	97.13
Howard L. & Elna J. Maloney	Lot 9 Block 5 2nd Add. to Rodgers Acres	7,500	97.13
Howard L. & Elna J. Maloney	Lot 10 Block 5 2nd Add. to Rodgers Acres	7,500	97.12
Howard L. & Elna J. Maloney	Lot 11 Block 5 2nd Add. to Rodgers Acres	7,500	97.13

<u>Name of Person on Assessment Roll</u>	<u>Description of Property</u>	<u>Area Assessed</u>	<u>Amount of Assessment</u>
Howard L. & Elma J. Maloney Box 546 Healdsburg, Cal.	Lot 12 Block 5 2nd Add. to Rodgers Acres	7,206	\$ 93.32
Jack & Barbara Draper 1715 S. Hill Street	Lot 1 Block 6 2nd Add. to Rodgers Acres	7,100	91.94
Jack & Barbara Draper	Lot 2 Block 6 2nd Add. to Rodgers Acres	7,000	90.65
J. L. Rodgers 341 E. 4th Avenue	Lot 3 Block 6 2nd Add. to Rodgers Acres	7,100	91.95
J. L. Rodgers	Lot 4 Block 6 2nd Add. to Rodgers Acres	7,950	102.95
Jack & Barbara Draper 1715 S. Hill Street	Lot 5 Block 6 2nd Add. to Rodgers Acres	7,950	102.95
J. L. Rodgers 341 E. 4th Avenue	Lot 1 Block 7 2nd Add. to Rodgers Acres	7,100	91.95
Howard L. & Elma J. Maloney Box 546 Healdsburg, Cal.	Lot 2 Block 7 2nd Add. to Rodgers Acres	7,000	90.65
Howard L. & Elma J. Maloney	Lot 3 Block 7 2nd Add. to Rodgers Acres	7,100	91.95
Howard L. & Elma J. Maloney	Lot 4 Block 7 2nd Add. to Rodgers Acres	7,950	102.95
J. L. Rodgers 341 E. 4th Avenue	Lot 5 Block 7 2nd Add. to Rodgers Acres	7,950	102.95
J. L. Rodgers	Lot 1 Block 3 2nd Add. to Rodgers Acres	7,486	96.95
J. L. Rodgers	Lot 2 Block 8 2nd Add. to Rodgers Acres	7,000	90.65
J. L. Rodgers	Lot 3 Block 8 2nd Add. to Rodgers Acres	7,000	90.65
J. L. Rodgers	Lot 4 Block 8 2nd Add. to Rodgers Acres	7,000	90.65
J. L. Rodgers	Lot 5 Block 8 2nd Add. to Rodgers Acres	7,000	90.65
J. L. Rodgers	Lot 6 Block 8 2nd Add. to Rodgers Acres	7,000	90.65
J. L. Rodgers	Lot 7 Block 8 2nd Add. to Rodgers Acres	7,000	90.66
J. L. Rodgers	Lot 8 Block 8 2nd Add. to Rodgers Acres	7,000	90.65
J. L. Rodgers	Lot 9 Block 8 2nd Add. to Rodgers Acres	7,000	90.65
J. L. Rodgers	Lot 10 Block 8 2nd Add. to Rodgers Acres	7,000	90.65
J. L. Rodgers	Lot 11 Block 8 2nd Add. to Rodgers Acres	7,000	90.65
J. L. Rodgers	Lot 12 Block 8 2nd Add. to Rodgers Acres	7,000	90.65
J. L. Rodgers	Lot 13 Block 8 2nd Add. to Rodgers Acres	7,200	93.24
Laird & Jerrelee Hyde 2515 S. Hill Street	Lot 14 Block 8 2nd Add. to Rodgers Acres	7,200	93.24
Laird & Jerrelee Hyde	Lot 15 Block 8 2nd Add. to Rodgers Acres	7,000	90.66
Laird & Jerrelee Hyde	Lot 16 Block 8 2nd Add. to Rodgers Acres	7,000	90.65
Laird & Jerrelee Hyde	Lot 17 Block 8 2nd Add. to Rodgers Acres	7,000	90.65

<u>Name of Person on Assessment Roll</u>	<u>Description of Property</u>	<u>Area Assessed</u>	<u>Amount of Assessment</u>
Laird & Jerrilee Hyde 2315 S. Hill Street	Lot 18 Block 8 2nd Add. to Rodgers Acres	7,000	\$ 90.65
Laird & Jerrilee Hyde	Lot 19 Block 8 2nd Add. to Rodgers	7,000	90.65
Howard L. & Elna J. Maloney Box 346 Healdsburg, Cal.	Lot 20 Block 8 2nd Add. to Rodgers Acres	7,000	90.65
Jack & Barbara Draper 1715 S. Hill Street	Lot 21 Block 8 2nd Add. to Rodgers Acres	7,000	90.65
Jack & Barbara Draper	Lot 22 Block 8 2nd Add. to Rodgers Acres	7,000	90.66
Jack & Barbara Draper	Lot 23 Block 8 2nd Add. to Rodgers Acres	7,000	90.65
Jack & Barbara Draper	Lot 24 Block 8 2nd Add. to Rodgers Acres	7,000	90.65
Jack & Barbara Draper	Lot 25 Block 8 2nd Add. to Rodgers Acres	7,000	90.65
Jack & Barbara Draper	Lot 26 Block 8 2nd Add. to Rodgers Acres	7,547	97.74
Jack & Barbara Draper	Lot 18 1st Add. to Rodgers Acres	21,969.70	284.51
Jack & Barbara Draper	Lot 19 1st Add. to Rodgers Acres	19,000	246.05
Jack & Barbara Draper	Lot 20 1st Add. to Rodgers Acres	19,000	246.05
Jack & Barbara Draper	Lot 21 1st Add. to Rodgers Acres	19,000	246.06
Jack & Barbara Draper	Lot 22 1st Add. to Rodgers Acres	19,000	246.05
Jack & Barbara Draper	Lot 23 1st Add. to Rodgers Acres	19,000	246.05
Jack & Barbara Draper	Lot 24 1st Add. to Rodgers Acres	19,000	246.06
M. Wayne & Maybelle Goin 3110 S. Marion Street	Lot 25 1st Add. to Rodgers Acres W. 90'	9,000	116.55
Dan & Evelyn Potter 3630 S. Sherman Street	S. 50' Lot 34 1st Add. to Rodgers Acres	9,500	123.03
Jack & Barbara Draper 1715 S. Hill Street	Lot 1 Block 1 Rodgersdale	9,055	117.26
Jack & Barbara Draper	Lot 2 Block 1 Rodgersdale	9,000	116.55
Jack & Barbara Draper	Lot 3 Block 1 Rodgersdale	9,000	116.56
Jack & Barbara Draper	Lot 4 Block 1 Rodgersdale	9,000	116.55
Jack & Barbara Draper	Lot 5 Block 1 Rodgersdale	9,000	116.55
Jack & Barbara Draper	Lot 6 Block 1 Rodgersdale	9,625	124.65
Jack & Barbara Draper	Lot 7 Block 1 Rodgersdale	9,625	124.65
Jack & Barbara Draper	Lot 8 Block 1 Rodgersdale	9,000	116.55
Jack & Barbara Draper	Lot 9 Block 1 Rodgersdale	9,000	116.56
Jack & Barbara Draper	Lot 10 Block 1 Rodgersdale	9,000	116.55
Jack & Barbara Draper	Lot 11 Block 1 Rodgersdale	9,000	116.55
Jack & Barbara Draper	Lot 12 Block 1 Rodgersdale	9,165.75	118.67
Charles R. & Retta Mae Draper 1715 S. Hill Street	Lot 1 Block 2 Rodgersdale	8,162	105.70
Charles R. & Retta Mae Draper	Lot 2 Block 2 Rodgersdale	8,162	105.70
Charles R. & Retta Mae Draper	Lot 3 Block 2 Rodgersdale	8,162	105.70
Charles R. & Retta Mae Draper	Lot 4 Block 2 Rodgersdale	8,162	105.70
Charles R. & Retta Mae Draper	Lot 5 Block 2 Rodgersdale	8,162	105.70
Charles R. & Retta Mae Draper	Lot 6 Block 2 Rodgersdale	8,162	105.70
Charles R. & Retta Mae Draper	Lot 7 Block 2 Rodgersdale	8,162	105.70

<u>Name of Person on Assessment Roll</u>	<u>Description of Property</u>	<u>Area Assessed</u>	<u>Amount of Assessment</u>
Charles R. & Retta Mae Draper 1715 S. Hill Street	Lot 8 Block 2 Rodgersdale	9,116	\$ 118.05
William M. & Patricia M. Stratton 542 University Healdsburg, California	Lot 9 Block 2 Rodgersdale	9,116	118.05
William M. & Patricia M. Stratton	Lot 10 Block 2 Rodgersdale	8,162	105.71
Charles & Retta Mae Draper 1715 S. Hill Street	Lot 11 Block 2 Rodgersdale	8,162	105.70
Charles & Retta Mae Draper	Lot 12 Block 2 Rodgersdale	8,162	105.70
Charles & Retta Mae Draper	Lot 13 Block 2 Rodgersdale	8,162	105.70
Charles & Retta Mae Draper	Lot 14 Block 2 Rodgersdale	8,162	105.70
Charles & Retta Mae Draper	Lot 15 Block 2 Rodgersdale	8,162	105.70
Charles & Retta Mae Draper	Lot 16 Block 2 Rodgersdale	8,162	105.70
William M. & Patricia M. Stratton 542 University Healdsburg, California	Lot 1 Block 3 Rodgersdale	8,162	105.70
William M. & Patricia M. Stratton	Lot 2 Block 3 Rodgersdale	8,162	105.70
William M. & Patricia M. Stratton	Lot 3 Block 3 Rodgersdale	8,162	105.70
William M. & Patricia M. Stratton	Lot 4 Block 3 Rodgersdale	8,162	105.70
William M. & Patricia M. Stratton	Lot 5 Block 3 Rodgersdale	8,162	105.70
William M. & Patricia M. Stratton	Lot 6 Block 3 Rodgersdale	8,162	105.70
William M. & Patricia M. Stratton	Lot 7 Block 3 Rodgersdale	8,162	105.70
William M. & Patricia M. Stratton	Lot 8 Block 3 Rodgersdale	9,116	118.05
Charles R. & Retta Mae Draper 1715 S. Hill Street	Lot 9 Block 3 Rodgersdale	9,116	118.05
Charles R. & Retta Mae Draper	Lot 10 Block 3 Rodgersdale	8,162	105.71
Jack & Barbara Draper 1715 S. Hill Street	Lot 11 Block 3 Rodgersdale	8,162	105.70
Jack & Barbara Draper	Lot 12 Block 3 Rodgersdale	8,162	105.70
Jack & Barbara Draper	Lot 13 Block 3 Rodgersdale	8,162	105.70
Jack & Barbara Draper	Lot 14 Block 3 Rodgersdale	8,162	105.70
Jack & Barbara Draper	Lot 15 Block 3 Rodgersdale	8,162	105.70
Jack & Barbara Draper	Lot 16 Block 3 Rodgersdale	8,162	105.70
Jack & Barbara Draper	Lot 1 Block 4 Rodgersdale	9,806.25	126.99
Jack & Barbara Draper	Lot 2 Block 4 Rodgersdale	9,250	119.79
Jack & Barbara Draper	Lot 3 Block 4 Rodgersdale	9,250	119.79
Jack & Barbara Draper	Lot 4 Block 4 Rodgersdale	9,250	119.79
Jack & Barbara Draper	Lot 5 Block 4 Rodgersdale	9,250	119.79
Jack & Barbara Draper	Lot 6 Block 4 Rodgersdale	9,250	119.79
Jack & Barbara Draper	Lot 7 Block 4 Rodgersdale	9,250	119.79
Jack & Barbara Draper	Lot 8 Block 4 Rodgersdale	9,250	119.79

<u>Name of Person on Assessment Roll</u>	<u>Description of Property</u>	<u>Area Assessed</u>	<u>Amount of Assessment</u>
Jack & Barbara Draper 1715 S. Hill Street	Lot 9 Block 4 Rodgersdale	9,250	\$ 119.79
Jack & Barbara Draper	Lot 10 Block 4 Rodgersdale	9,250	119.79
Jack & Barbara Draper	Lot 11 Block 4 Rodgersdale	9,250	119.79
Jack & Barbara Draper	Lot 12 Block 4 Rodgersdale	10,000	129.50
Jack & Barbara Draper	Lot 13 Block 4 Rodgersdale	10,000	129.50
Jack & Barbara Draper	Lot 14 Block 4 Rodgersdale	9,250	119.79
Jack & Barbara Draper	Lot 15 Block 4 Rodgersdale	9,250	119.79
Jack & Barbara Draper	Lot 16 Block 4 Rodgersdale	9,250	119.79
Jack & Barbara Draper	Lot 17 Block 4 Rodgersdale	9,250	119.79
Jack & Barbara Draper	Lot 18 Block 4 Rodgersdale	9,250	119.79
Jack & Barbara Draper	Lot 19 Block 4 Rodgersdale	9,250	119.79
Jack & Barbara Draper	Lot 20 Block 4 Rodgersdale	9,250	119.79
Jack & Barbara Draper	Lot 21 Block 4 Rodgersdale	9,250	119.79
Jack & Barbara Draper	Lot 22 Block 4 Rodgersdale	9,250	119.79
Jack & Barbara Draper	Lot 23 Block 4 Rodgersdale	9,250	119.79
Jack & Barbara Draper	Lot 24 Block 4 Rodgersdale	9,922.50	128.50
Jack & Barbara Draper	Block 5 Rodgersdale	109,857.50	1,422.68
Jack & Barbara Draper	Lot 1 Block 6 Rodgersdale	10,023.75	129.81
Jack & Barbara Draper	Lot 2 Block 6 Rodgersdale	9,250	119.79
Jack & Barbara Draper	Lot 3 Block 6 Rodgersdale	9,250	119.79
Jack & Barbara Draper	Lot 4 Block 6 Rodgersdale	9,250	119.79
Jack & Barbara Draper	Lot 5 Block 6 Rodgersdale	9,250	119.79
Jack & Barbara Draper	Lot 6 Block 6 Rodgersdale	9,250	119.79
Jack & Barbara Draper	Lot 7 Block 6 Rodgersdale	9,250	119.79
Jack & Barbara Draper	Lot 8 Block 6 Rodgersdale	9,250	119.79
Jack & Barbara Draper	Lot 9 Block 6 Rodgersdale	9,250	119.79
Jack & Barbara Draper	Lot 10 Block 6 Rodgersdale	9,250	119.79
Jack & Barbara Draper	Lot 11 Block 6 Rodgersdale	9,250	119.79
Jack & Barbara Draper	Lot 12 Block 6 Rodgersdale	10,000	129.50
Jack & Barbara Draper	Lot 13 Block 6 Rodgersdale	10,000	129.50
Jack & Barbara Draper	Lot 14 Block 6 Rodgersdale	9,250	119.79
Jack & Barbara Draper	Lot 15 Block 6 Rodgersdale	9,250	119.79
Jack & Barbara Draper	Lot 16 Block 6 Rodgersdale	9,250	119.79
Jack & Barbara Draper	Lot 17 Block 6 Rodgersdale	9,250	119.79
Jack & Barbara Draper	Lot 18 Block 6 Rodgersdale	9,250	119.79
Jack & Barbara Draper	Lot 19 Block 6 Rodgersdale	9,250	119.79
Jack & Barbara Draper	Lot 20 Block 6 Rodgersdale	9,250	119.79
Jack & Barbara Draper	Lot 21 Block 6 Rodgersdale	9,250	119.79
Jack & Barbara Draper	Lot 22 Block 6 Rodgersdale	9,250	119.79
Jack & Barbara Draper	Lot 23 Block 6 Rodgersdale	9,250	119.79
Jack & Barbara Draper	Lot 24 Block 6 Rodgersdale	10,116.25	131.01

<u>Name of Person on Assessment Roll</u>	<u>Description of Property</u>	<u>Area Assessed</u>	<u>Amount of Assessment</u>
Jack & Barbara Draper	Lot 1 Block 7 Rodgersdale	7,248.95	\$ 93.88
Jack & Barbara Draper	Lot 2 Block 7 Rodgersdale	6,999.12	90.64
Jack & Barbara Draper	Lot 3 Block 7 Rodgersdale	6,999.12	90.64
Jack & Barbara Draper	Lot 4 Block 7 Rodgersdale	6,999.12	90.64
Jack & Barbara Draper	Lot 5 Block 7 Rodgersdale	6,999.12	90.64
Jack & Barbara Draper	Lot 6 Block 7 Rodgersdale	7,485.17	96.93
Jack & Barbara Draper	Lot 7 Block 7 Rodgersdale	7,484.40	96.92
Jack & Barbara Draper	Lot 8 Block 7 Rodgersdale	6,998.40	90.63
Jack & Barbara Draper	Lot 9 Block 7 Rodgersdale	6,998.40	90.63
Jack & Barbara Draper	Lot 10 Block 7 Rodgersdale	6,998.40	90.63
Jack & Barbara Draper	Lot 11 Block 7 Rodgersdale	6,998.40	90.63
Jack & Barbara Draper	Lot 12 Block 7 Rodgersdale	7,314.30	94.72
Jack & Barbara Draper	Lot 1 Block 8 Rodgersdale	8,291.32	107.37
Jack & Barbara Draper	Lot 2 Block 8 Rodgersdale	7,844	101.59
Jack & Barbara Draper	Lot 3 Block 8 Rodgersdale	7,844	101.58
Jack & Barbara Draper	Lot 4 Block 8 Rodgersdale	7,844	101.58
Jack & Barbara Draper	Lot 5 Block 8 Rodgersdale	7,844	101.58
Jack & Barbara Draper	Lot 6 Block 8 Rodgersdale	7,844	101.58
Jack & Barbara Draper	Lot 7 Block 8 Rodgersdale	7,844	101.58
Jack & Barbara Draper	Lot 8 Block 8 Rodgersdale	7,844	101.58
Jack & Barbara Draper	Lot 9 Block 8 Rodgersdale	7,844	101.59
Jack & Barbara Draper	Lot 10 Block 8 Rodgersdale	8,480	109.82
Jack & Barbara Draper	Lot 11 Block 8 Rodgersdale	8,480	109.82
Jack & Barbara Draper	Lot 12 Block 8 Rodgersdale	7,844	101.58
Jack & Barbara Draper	Lot 13 Block 8 Rodgersdale	7,844	101.58
Jack & Barbara Draper	Lot 14 Block 8 Rodgersdale	7,844	101.58
Jack & Barbara Draper	Lot 15 Block 8 Rodgersdale	7,844	101.58
Jack & Barbara Draper	Lot 16 Block 8 Rodgersdale	7,844	101.58
Jack & Barbara Draper	Lot 17 Block 8 Rodgersdale	7,844	101.58
Jack & Barbara Draper	Lot 18 Block 8 Rodgersdale	7,344	101.58
Jack & Barbara Draper	Lot 19 Block 8 Rodgersdale	7,844	101.58
Jack & Barbara Draper	Lot 20 Block 8 Rodgersdale	8,291.32	107.38
Jack & Barbara Draper	Lot 1 Block 9 Rodgersdale	8,291.32	107.37
Jack & Barbara Draper	Lot 2 Block 9 Rodgersdale	7,844	101.58
Jack & Barbara Draper	Lot 3 Block 9 Rodgersdale	7,844	101.58
Jack & Barbara Draper	Lot 4 Block 9 Rodgersdale	7,844	101.58
Jack & Barbara Draper	Lot 5 Block 9 Rodgersdale	7,844	101.59
Jack & Barbara Draper	Lot 6 Block 9 Rodgersdale	7,844	101.58
Jack & Barbara Draper	Lot 7 Block 9 Rodgersdale	7,844	101.58
Jack & Barbara Draper	Lot 8 Block 9 Rodgersdale	7,844	101.58
Jack & Barbara Draper	Lot 9 Block 9 Rodgersdale	7,844	101.58

<u>Name of Person on Assessment Roll</u>	<u>Description of Property</u>	<u>Area Assessed</u>	<u>Amount of Assessment</u>
Jack & Barbara Draper	Lot 10 Block 9 Rodgersdale	8,480	\$ 109.82
Jack & Barbara Draper	Lot 11 Block 9 Rodgersdale	8,480	109.82
Jack & Barbara Draper	Lot 12 Block 9 Rodgersdale	7,844	101.58
Jack & Barbara Draper	Lot 13 Block 9 Rodgersdale	7,844	101.58
Jack & Barbara Draper	Lot 14 Block 9 Rodgersdale	7,844	101.59
Jack & Barbara Draper	Lot 15 Block 9 Rodgersdale	7,844	101.58
Jack & Barbara Draper	Lot 16 Block 9 Rodgersdale	7,844	101.58
Jack & Barbara Draper	Lot 17 Block 9 Rodgersdale	7,844	101.58
Jack & Barbara Draper	Lot 18 Block 9 Rodgersdale	7,844	101.58
Jack & Barbara Draper	Lot 19 Block 9 Rodgersdale	7,844	101.58
Jack & Barbara Draper	Lot 20 Block 9 Rodgersdale	8,291.32	107.38
J. Francyl & Mary B. Howard Box 489	Lot 1 Block 10 Rodgersdale	9,015.60	116.75
J. Francyl & Mary B. Howard	Lot 2 Block 10 Rodgersdale	8,140	105.41
J. Francyl & Mary B. Howard	Lot 3 Block 10 Rodgersdale	8,140	105.42
J. Francyl & Mary B. Howard	Lot 4 Block 10 Rodgersdale	8,140	105.41
J. Francyl & Mary B. Howard	Lot 5 Block 10 Rodgersdale	8,140	105.42
J. Francyl & Mary B. Howard	Lot 6 Block 10 Rodgersdale	8,140	105.41
J. Francyl & Mary B. Howard	Lot 7 Block 10 Rodgersdale	8,140	105.42
J. Francyl & Mary B. Howard	Lot 8 Block 10 Rodgersdale	8,140	105.41
J. Francyl & Mary B. Howard	Lot 9 Block 10 Rodgersdale	8,140	105.42
J. Francyl & Mary B. Howard	Lot 10 Block 10 Rodgersdale	8,140	105.42
Jack & Barbara Draper 1715 S. Hill Street	Lot 11 Block 10 Rodgersdale	8,140	105.42
Jack & Barbara Draper	Lot 12 Block 10 Rodgersdale	8,800	113.96
Jack & Barbara Draper	Lot 13 Block 10 Rodgersdale	8,800	113.96
Jack & Barbara Draper	Lot 14 Block 10 Rodgersdale	8,140	105.41
Jack & Barbara Draper	Lot 15 Block 10 Rodgersdale	8,140	105.42
Jack & Barbara Draper	Lot 16 Block 10 Rodgersdale	8,140	105.41
Jack & Barbara Draper	Lot 17 Block 10 Rodgersdale	8,140	105.42
Jack & Barbara Draper	Lot 18 Block 10 Rodgersdale	8,140	105.41
Jack & Barbara Draper	Lot 19 Block 10 Rodgersdale	8,140	105.42
Jack & Barbara Draper 1715 S. Hill Street	Lot 20 Block 10 Rodgersdale	8,140	105.41
Jack & Barbara Draper	Lot 21 Block 10 Rodgersdale	8,140	105.42
Jack & Barbara Draper	Lot 22 Block 10 Rodgersdale	8,140	105.41
Jack & Barbara Draper	Lot 23 Block 10 Rodgersdale	8,140	105.42
Jack & Barbara Draper	Lot 24 Block 10 Rodgersdale	9,121.20	118.12
Jack & Barbara Draper	Lot 1 Block 11 Rodgersdale	7,330.82	94.94
Jack & Barbara Draper	Lot 2 Block 11 Rodgersdale	6,998.40	90.63
Jack & Barbara Draper	Lot 3 Block 11 Rodgersdale	6,998.40	90.63
Jack & Barbara Draper	Lot 4 Block 11 Rodgersdale	6,998.40	90.63
Jack & Barbara Draper	Lot 5 Block 11 Rodgersdale	6,998.40	90.63

<u>Name of Person on Assessment Roll</u>	<u>Description of Property</u>	<u>Area Assessed</u>	<u>Amount of Assessment</u>
Jack & Barbara Draper	Lot 5 Block 11 Rodgersdale	7,484.40	\$ 96.93
Jack & Barbara Draper	Lot 7 Block 11 Rodgersdale	7,484.40	96.92
Jack & Barbara Draper	Lot 8 Block 11 Rodgersdale	6,998.40	90.63
Jack & Barbara Draper	Lot 9 Block 11 Rodgersdale	6,998.40	90.63
Jack & Barbara Draper	Lot 10 Block 11 Rodgersdale	6,998.40	90.63
Jack & Barbara Draper	Lot 11 Block 11 Rodgersdale	6,998.40	90.63
Jack & Barbara Draper	Lot 12 Block 11 Rodgersdale	7,396.92	95.79
J. Francyl & Mary B. Howard Box 489	Lot 1 Block 12 Rodgersdale	9,153.10	118.54
J. Francyl & Mary B. Howard	Lot 2 Block 12 Rodgersdale	8,140	105.42
J. Francyl & Mary B. Howard	Lot 3 Block 12 Rodgersdale	8,140	105.41
J. Francyl & Mary B. Howard	Lot 4 Block 12 Rodgersdale	8,140	105.42
J. Francyl & Mary B. Howard	Lot 5 Block 12 Rodgersdale	8,140	105.41
J. Francyl & Mary B. Howard	Lot 6 Block 12 Rodgersdale	8,140	105.42
J. Francyl & Mary B. Howard	Lot 7 Block 12 Rodgersdale	8,140	105.41
J. Francyl & Mary B. Howard	Lot 8 Block 12 Rodgersdale	8,140	105.42
J. Francyl & Mary B. Howard	Lot 9 Block 12 Rodgersdale	8,140	105.41
J. Francyl & Mary B. Howard	Lot 10 Block 12 Rodgersdale	8,140	105.42
Jack & Barbara Draper 1715 S. Hill Street	Lot 11 Block 12 Rodgersdale	8,140	105.41
Jack & Barbara Draper	Lot 12 Block 12 Rodgersdale	8,800	113.96
Jack & Barbara Draper	Lot 13 Block 12 Rodgersdale	8,800	113.96
Jack & Barbara Draper	Lot 14 Block 12 Rodgersdale	8,140	105.41
Jack & Barbara Draper	Lot 15 Block 12 Rodgersdale	8,140	105.42
Jack & Barbara Draper	Lot 16 Block 12 Rodgersdale	8,140	105.41
Jack & Barbara Draper	Lot 17 Block 12 Rodgersdale	8,140	105.42
Jack & Barbara Draper	Lot 18 Block 12 Rodgersdale	8,140	105.41
Jack & Barbara Draper	Lot 19 Block 12 Rodgersdale	8,140	105.42
Jack & Barbara Draper	Lot 20 Block 12 Rodgersdale	8,140	105.41
Jack & Barbara Draper	Lot 21 Block 12 Rodgersdale	8,140	105.42
Jack & Barbara Draper	Lot 22 Block 12 Rodgersdale	8,140	105.41
Jack & Barbara Draper	Lot 23 Block 12 Rodgersdale	8,140	105.42
Jack & Barbara Draper	Lot 24 Block 12 Rodgersdale	9,293.90	120.36
William M. & Patricia M. Stratton 542 University Healdsburg, California	Lot 1 Block 13 Rodgersdale	9,968.49	129.09
William M. & Patricia M. Stratton	Lot 2 Block 13 Rodgersdale	9,410.40	121.87
William M. & Patricia M. Stratton	Lot 3 Block 13 Rodgersdale	9,410.40	121.87
William M. & Patricia M. Stratton	Lot 4 Block 13 Rodgersdale	9,410.40	121.86
William M. & Patricia M. Stratton	Lot 5 Block 13 Rodgersdale	9,410.40	121.87
Jack & Barbara Draper 1715 S. Hill Street	Lot 6 Block 13 Rodgersdale	10,063.90	130.33

<u>Name of Person on Assessment Roll</u>	<u>Description of Property</u>	<u>Area Assessed</u>	<u>Amount of Assessment</u>
Jack & Barbara Draper	Lot 7 Block 13 Rodgersdale	10,064.67	\$ 130.34
William M. & Patricia M. Stratton 342 University Healdsburg, California	Lot 8 Block 13 Rodgersdale	9,411.12	121.88
William M. & Patricia M. Stratton	Lot 9 Block 13 Rodgersdale	9,411.12	121.88
William M. & Patricia M. Stratton	Lot 10 Block 13 Rodgersdale	9,411.12	121.88
William M. & Patricia M. Stratton	Lot 11 Block 13 Rodgersdale	9,411.12	121.88
William M. & Patricia M. Stratton	Lot 12 Block 13 Rodgersdale	10,089.50	130.66
J. Francyl & Mary B. Howard Box 489	Lot 1 Block 14 Rodgersdale	8,896.65	115.21
J. Francyl & Mary B. Howard	Lot 2 Block 14 Rodgersdale	7,770.0	100.63
J. Francyl & Mary B. Howard	Lot 3 Block 14 Rodgersdale	7,770.0	100.62
J. Francyl & Mary B. Howard	Lot 4 Block 14 Rodgersdale	7,770.0	100.62
J. Francyl & Mary B. Howard	Lot 5 Block 14 Rodgersdale	7,770.0	100.62
J. Francyl & Mary B. Howard	Lot 6 Block 14 Rodgersdale	7,770.0	100.63
J. Francyl & Mary B. Howard	Lot 7 Block 14 Rodgersdale	7,770.0	100.62
J. Francyl & Mary B. Howard	Lot 8 Block 14 Rodgersdale	7,770.0	100.62
J. Francyl & Mary B. Howard	Lot 9 Block 14 Rodgersdale	7,770.0	100.62
J. Francyl & Mary B. Howard	Lot 10 Block 14 Rodgersdale	7,770.0	100.63
Jack & Barbara Draper 1715 S. Hill Street	Lot 11 Block 14 Rodgersdale	7,770.0	100.62
Jack & Barbara Draper	Lot 12 Block 14 Rodgersdale	8,400	108.78
Jack & Barbara Draper	Lot 13 Block 14 Rodgersdale	8,417.60	109.01
Jack & Barbara Draper	Lot 14 Block 14 Rodgersdale	7,786.28	100.83
Jack & Barbara Draper	Lot 15 Block 14 Rodgersdale	7,786.28	100.83
Jack & Barbara Draper	Lot 16 Block 14 Rodgersdale	7,786.28	100.84
Jack & Barbara Draper	Lot 17 Block 14 Rodgersdale	7,786.28	100.83
Jack & Barbara Draper	Lot 18 Block 14 Rodgersdale	7,786.28	100.84
Jack & Barbara Draper	Lot 19 Block 14 Rodgersdale	7,786.28	100.83
Jack & Barbara Draper	Lot 20 Block 14 Rodgersdale	7,786.28	100.83
Jack & Barbara Draper	Lot 21 Block 14 Rodgersdale	7,786.29	100.84
Jack & Barbara Draper	Lot 22 Block 14 Rodgersdale	7,786.28	100.83
Jack & Barbara Draper	Lot 23 Block 14 Rodgersdale	7,786.28	100.84
Jack & Barbara Draper	Lot 24 Block 14 Rodgersdale	9,049.97	117.20
Jack & Barbara Draper	Lot 1 Block 15 Rodgersdale	10,006.54	129.59
Jack & Barbara Draper	Lot 2 Block 15 Rodgersdale	9,306	120.52
Jack & Barbara Draper	Lot 3 Block 15 Rodgersdale	9,306	120.51
Jack & Barbara Draper	Lot 4 Block 15 Rodgersdale	9,306	120.52
Jack & Barbara Draper	Lot 5 Block 15 Rodgersdale	9,306	120.51
Jack & Barbara Draper	Lot 6 Block 15 Rodgersdale	9,952.25	128.88
Jack & Barbara Draper	Lot 7 Block 15 Rodgersdale	9,952.25	128.88

<u>Name of Person on Assessment Roll</u>	<u>Description of Property</u>	<u>Area Assessed</u>	<u>Amount of Assessment</u>
Jack & Barbara Draper	Lot 8 Block 15 Rodgersdale	9,306	\$ 120.52
Jack & Barbara Draper	Lot 9 Block 15 Rodgersdale	9,306	120.51
Jack & Barbara Draper	Lot 10 Block 15 Rodgersdale	9,306	120.51
Jack & Barbara Draper	Lot 11 Block 15 Rodgersdale	9,306	120.52
Jack & Barbara Draper	Lot 12 Block 15 Rodgersdale	10,109.94	130.93
Jack & Barbara Draper	Lot 1 Block 16 Rodgersdale	7,950	102.95
Jack & Barbara Draper	Lot 2 Block 16 Rodgersdale	7,420	96.09
Jack & Barbara Draper	Lot 3 Block 16 Rodgersdale	7,420	96.09
Jack & Barbara Draper	Lot 4 Block 16 Rodgersdale	7,420	96.09
Jack & Barbara Draper	Lot 5 Block 16 Rodgersdale	7,420	96.09
Jack & Barbara Draper	Lot 6 Block 16 Rodgersdale	7,420	96.09
Jack & Barbara Draper	Lot 7 Block 16 Rodgersdale	7,420	96.09
Jack & Barbara Draper	Lot 8 Block 16 Rodgersdale	7,632	98.84
Jack & Barbara Draper	Lot 9 Block 16 Rodgersdale	7,632	98.84
Jack & Barbara Draper	Lot 10 Block 16 Rodgersdale	7,420	96.09
Jack & Barbara Draper	Lot 11 Block 16 Rodgersdale	7,420	96.09
Jack & Barbara Draper	Lot 12 Block 16 Rodgersdale	7,420	96.09
Jack & Barbara Draper	Lot 13 Block 16 Rodgersdale	7,420	96.09
Jack & Barbara Draper	Lot 14 Block 16 Rodgersdale	7,420	96.09
Jack & Barbara Draper	Lot 15 Block 16 Rodgersdale	7,420	96.09
Jack & Barbara Draper	Lot 16 Block 16 Rodgersdale	7,950	102.95
Jack & Barbara Draper	Lot 1 Block 17 Rodgersdale	7,950	102.95
Jack & Barbara Draper	Lot 2 Block 17 Rodgersdale	7,420	96.09
Jack & Barbara Draper	Lot 3 Block 17 Rodgersdale	7,420	96.09
Jack & Barbara Draper	Lot 4 Block 17 Rodgersdale	7,420	96.09
Jack & Barbara Draper	Lot 5 Block 17 Rodgersdale	7,420	96.09
Jack & Barbara Draper	Lot 6 Block 17 Rodgersdale	7,420	96.09
Jack & Barbara Draper	Lot 7 Block 17 Rodgersdale	7,420	96.09
Jack & Barbara Draper	Lot 8 Block 17 Rodgersdale	7,632	98.84
Jack & Barbara Draper	Lot 9 Block 17 Rodgersdale	7,632	98.84
Jack & Barbara Draper	Lot 10 Block 17 Rodgersdale	7,420	96.09
Jack & Barbara Draper	Lot 11 Block 17 Rodgersdale	7,420	96.09
Jack & Barbara Draper	Lot 12 Block 17 Rodgersdale	7,420	96.09
Jack & Barbara Draper	Lot 13 Block 17 Rodgersdale	7,420	96.09
Jack & Barbara Draper	Lot 14 Block 17 Rodgersdale	7,420	96.09
Jack & Barbara Draper	Lot 15 Block 17 Rodgersdale	7,420	96.09
Jack & Barbara Draper	Lot 16 Block 17 Rodgersdale	7,950	102.96
J. Francyl & Mary B. Howard	Lot 1 Block 18 Rodgersdale	11,167.20	144.62
J. Francyl & Mary B. Howard	Lot 2 Block 18 Rodgersdale	9,564.5	123.86
J. Francyl & Mary B. Howard	Lot 3 Block 18 Rodgersdale	9,564.5	123.86
J. Francyl & Mary B. Howard	Lot 4 Block 18 Rodgersdale	9,564.5	123.86

<u>Name of Person on Assessment Roll</u>	<u>Description of Property</u>	<u>Area Assessed</u>	<u>Amount of Assessment</u>
J. Francyl & Mary B. Howard Box 489	Lot 5 Block 18 Rodgersdale	9,564.5	\$ 123.86
J. Francyl & Mary B. Howard	Lot 6 Block 18 Rodgersdale	9,564.5	123.87
J. Francyl & Mary B. Howard	Lot 7 Block 18 Rodgersdale	9,564.5	123.86
J. Francyl & Mary B. Howard	Lot 8 Block 18 Rodgersdale	9,564.5	123.86
J. Francyl & Mary B. Howard	Lot 9 Block 18 Rodgersdale	9,564.5	123.86
J. Francyl & Mary B. Howard	Lot 10 Block 18 Rodgersdale	9,564.5	123.87
Jack & Barbara Draper 1715 S. Hill Street	Lot 11 Block 18 Rodgersdale	9,564.50	123.86
Jack & Barbara Draper	Lot 12 Block 18 Rodgersdale	10,340	133.91
Jack & Barbara Draper	Lot 13 Block 18 Rodgersdale	10,340	133.91
Jack & Barbara Draper	Lot 14 Block 18 Rodgersdale	9,564.50	123.86
Jack & Barbara Draper	Lot 15 Block 18 Rodgersdale	9,564.50	123.86
Jack & Barbara Draper	Lot 16 Block 18 Rodgersdale	9,564.50	123.86
Jack & Barbara Draper	Lot 17 Block 18 Rodgersdale	9,564.50	123.86
Jack & Barbara Draper	Lot 18 Block 18 Rodgersdale	9,564.50	123.86
Jack & Barbara Draper	Lot 19 Block 18 Rodgersdale	9,564.50	123.86
Jack & Barbara Draper	Lot 20 Block 18 Rodgersdale	9,564.50	123.87
Jack & Barbara Draper	Lot 21 Block 18 Rodgersdale	9,564.50	123.86
Jack & Barbara Draper	Lot 22 Block 18 Rodgersdale	9,564.50	123.86
Jack & Barbara Draper	Lot 23 Block 18 Rodgersdale	9,564.50	123.86
Jack & Barbara Draper	Lot 24 Block 18 Rodgersdale	11,357.20	147.08
Jack & Barbara Draper	Lot 1 Block 19 Rodgersdale	10,173.27	131.75
Jack & Barbara Draper	Lot 2 Block 19 Rodgersdale	9,306	120.51
Jack & Barbara Draper	Lot 3 Block 19 Rodgersdale	9,306	120.52
Jack & Barbara Draper	Lot 4 Block 19 Rodgersdale	9,306	120.51
Jack & Barbara Draper	Lot 5 Block 19 Rodgersdale	9,306	120.52
Jack & Barbara Draper	Lot 6 Block 19 Rodgersdale	9,952.25	128.88
Jack & Barbara Draper	Lot 7 Block 19 Rodgersdale	9,952.25	128.89
Jack & Barbara Draper	Lot 8 Block 19 Rodgersdale	9,306	120.51
Jack & Barbara Draper	Lot 9 Block 19 Rodgersdale	9,306	120.52
Jack & Barbara Draper	Lot 10 Block 19 Rodgersdale	9,306	120.51
Jack & Barbara Draper	Lot 11 Block 19 Rodgersdale	9,952.25	120.52
Jack & Barbara Draper	Lot 12 Block 19 Rodgersdale	10,231.43	132.50
J. Francyl & Mary B. Howard Box 389	Lot 1 Block 20 Rodgersdale	11,393.39	147.55
J. Francyl & Mary B. Howard	Lot 2 Block 20 Rodgersdale	9,564.50	123.86
J. Francyl & Mary B. Howard	Lot 3 Block 20 Rodgersdale	9,564.50	123.86
J. Francyl & Mary B. Howard	Lot 4 Block 20 Rodgersdale	9,564.50	123.86
J. Francyl & Mary B. Howard	Lot 5 Block 20 Rodgersdale	9,564.50	123.86
J. Francyl & Mary B. Howard	Lot 6 Block 20 Rodgersdale	9,564.90	123.86
J. Francyl & Mary B. Howard	Lot 7 Block 20 Rodgersdale	9,564.50	123.87
J. Francyl & Mary B. Howard	Lot 8 Block 20 Rodgersdale	9,564.50	123.86

<u>Name of Person on Assessment Roll</u>	<u>Description of Property</u>	<u>Area Assessed</u>	<u>Amount of Assessment</u>
J. Francyl & Mary B. Howard Box 389	Lot 9 Block 20 Rodgersdale	9,564.50	\$ 123.86
J. Francyl & Mary B. Howard	Lot 10 Block 20 Rodgersdale	9,564.50	123.87
Jack & Barbara Draper 1715 S. Hill	Lot 11 Block 20 Rodgersdale	9,564.50	123.86
Jack & Barbara Draper	Lot 12 Block 20 Rodgersdale	10,340	133.91
Jack & Barbara Draper	Lot 13 Block 20 Rodgersdale	10,340	133.91
Jack & Barbara Draper	Lot 14 Block 20 Rodgersdale	9,564.50	123.86
Jack & Barbara Draper	Lot 15 Block 20 Rodgersdale	9,564.50	123.86
Jack & Barbara Draper	Lot 16 Block 20 Rodgersdale	9,564.50	123.86
Jack & Barbara Draper	Lot 17 Block 20 Rodgersdale	9,564.50	123.86
Jack & Barbara Draper	Lot 18 Block 20 Rodgersdale	9,564.50	123.86
Jack & Barbara Draper	Lot 19 Block 20 Rodgersdale	9,564.50	123.86
Jack & Barbara Draper	Lot 20 Block 20 Rodgersdale	9,564.50	123.87
Jack & Barbara Draper	Lot 21 Block 20 Rodgersdale	9,564.50	123.86
Jack & Barbara Draper	Lot 22 Block 20 Rodgersdale	9,564.50	123.86
Jack & Barbara Draper	Lot 23 Block 20 Rodgersdale	9,564.50	123.86
Jack & Barbara Draper	Lot 24 Block 20 Rodgersdale	11,515.97	150.04
Jack & Barbara Draper	Lot 1 Block 21 Rodgersdale	10,288.30	133.24
Jack & Barbara Draper	Lot 2 Block 21 Rodgersdale	9,306	120.51
Jack & Barbara Draper	Lot 3 Block 21 Rodgersdale	9,306	120.52
Jack & Barbara Draper	Lot 4 Block 21 Rodgersdale	9,306	120.51
Jack & Barbara Draper	Lot 5 Block 21 Rodgersdale	9,306	120.52
Jack & Barbara Draper	Lot 6 Block 21 Rodgersdale	9,952.25	128.88
Jack & Barbara Draper	Lot 7 Block 21 Rodgersdale	9,952.25	128.88
Jack & Barbara Draper	Lot 8 Block 21 Rodgersdale	9,306	120.52
Jack & Barbara Draper	Lot 9 Block 21 Rodgersdale	9,306	120.51
Jack & Barbara Draper	Lot 10 Block 21 Rodgersdale	9,306	120.52
Jack & Barbara Draper	Lot 11 Block 21 Rodgersdale	9,306	120.51
Jack & Barbara Draper	Lot 12 Block 21 Rodgersdale	10,405.92	134.76
Jack & Barbara Draper	Lot 1 Block 22 Rodgersdale	7,632	98.84
Jack & Barbara Draper	Lot 2 Block 22 Rodgersdale	7,420	96.09
Jack & Barbara Draper	Lot 3 Block 22 Rodgersdale	7,420	96.09
Jack & Barbara Draper	Lot 4 Block 22 Rodgersdale	7,420	96.09
Jack & Barbara Draper	Lot 5 Block 22 Rodgersdale	7,420	96.09
Jack & Barbara Draper	Lot 6 Block 22 Rodgersdale	7,420	96.09
Jack & Barbara Draper	Lot 7 Block 22 Rodgersdale	7,420	96.09
Jack & Barbara Draper	Lot 8 Block 22 Rodgersdale	7,950	102.95
Jack & Barbara Draper	Lot 9 Block 22 Rodgersdale	7,950	102.96
Jack & Barbara Draper	Lot 10 Block 22 Rodgersdale	7,420	96.09
Jack & Barbara Draper	Lot 11 Block 22 Rodgersdale	7,420	96.09
Jack & Barbara Draper	Lot 12 Block 22 Rodgersdale	7,420	96.09

<u>Name of Person on Assessment Roll</u>	<u>Description of Property</u>	<u>Area Assessed</u>	<u>Amount of Assessment</u>
Jack & Barbara Draper 1715 S. Hill Street	Lot 13 Block 22 Rodgersdale	7,420	\$ 96.09
Jack & Barbara Draper	Lot 14 Block 22 Rodgersdale	7,420	96.09
Jack & Barbara Draper	Lot 15 Block 22 Rodgersdale	7,420	96.09
Jack & Barbara Draper	Lot 16 Block 22 Rodgersdale	7,632	98.84
Jack & Barbara Draper	Lot 1 Block 23 Rodgersdale	7,632	98.84
Jack & Barbara Draper	Lot 2 Block 23 Rodgersdale	7,420	96.09
Jack & Barbara Draper	Lot 3 Block 23 Rodgersdale	7,420	96.09
Jack & Barbara Draper	Lot 4 Block 23 Rodgersdale	7,420	96.09
Jack & Barbara Draper	Lot 5 Block 23 Rodgersdale	7,420	96.09
Jack & Barbara Draper	Lot 6 Block 23 Rodgersdale	7,420	96.09
Jack & Barbara Draper	Lot 7 Block 23 Rodgersdale	7,420	96.09
Jack & Barbara Draper	Lot 8 Block 23 Rodgersdale	7,950	102.95
Jack & Barbara Draper	Lot 9 Block 23 Rodgersdale	7,950	102.95
Jack & Barbara Draper	Lot 10 Block 23 Rodgersdale	7,420	96.09
Jack & Barbara Draper	Lot 11 Block 23 Rodgersdale	7,420	96.09
Jack & Barbara Draper	Lot 12 Block 23 Rodgersdale	7,420	96.09
Jack & Barbara Draper	Lot 13 Block 23 Rodgersdale	7,420	96.09
Jack & Barbara Draper	Lot 14 Block 23 Rodgersdale	7,420	96.09
Jack & Barbara Draper	Lot 15 Block 23 Rodgersdale	7,420	96.09
Jack & Barbara Draper	Lot 16 Block 23 Rodgersdale	7,632	98.84
J. Francyl & Mary B. Howard Box 489	Lot 1 Block 24 Rodgersdale	11,627.33	150.58
J. Francyl & Mary B. Howard	Lot 2 Block 24 Rodgersdale	9,564.50	123.86
J. Francyl & Mary B. Howard	Lot 3 Block 24 Rodgersdale	9,564.50	123.86
J. Francyl & Mary B. Howard	Lot 4 Block 24 Rodgersdale	9,564.50	123.86
J. Francyl & Mary B. Howard	Lot 5 Block 24 Rodgersdale	9,564.50	123.87
J. Francyl & Mary B. Howard	Lot 6 Block 24 Rodgersdale	9,564.50	123.86
J. Francyl & Mary B. Howard	Lot 7 Block 24 Rodgersdale	9,564.50	123.86
J. Francyl & Mary B. Howard	Lot 8 Block 24 Rodgersdale	9,564.50	123.86
J. Francyl & Mary B. Howard	Lot 9 Block 24 Rodgersdale	9,564.50	123.87
J. Francyl & Mary B. Howard	Lot 10 Block 24 Rodgersdale	9,564.50	123.86
J. Francyl & Mary B. Howard	Lot 11 Block 24 Rodgersdale	9,564.50	123.86
Jack & Barbara Draper 1715 S. Hill Street	Lot 12 Block 24 Rodgersdale	10,340	133.91
Jack & Barbara Draper	Lot 13 Block 24 Rodgersdale	10,340	133.91
Jack & Barbara Draper	Lot 14 Block 24 Rodgersdale	9,564.50	123.86
Jack & Barbara Draper	Lot 15 Block 24 Rodgersdale	9,564.50	123.86
Jack & Barbara Draper	Lot 16 Block 24 Rodgersdale	9,564.50	123.86
Jack & Barbara Draper	Lot 17 Block 24 Rodgersdale	9,564.50	123.86
Jack & Barbara Draper	Lot 18 Block 24 Rodgersdale	9,564.50	123.86
Jack & Barbara Draper	Lot 19 Block 24 Rodgersdale	9,564.50	123.86
Jack & Barbara Draper	Lot 20 Block 24 Rodgersdale	9,564.50	123.87

<u>Name of Person on Assessment Roll</u>	<u>Description of Property</u>	<u>Area Assessed</u>	<u>Amount of Assessment</u>
Jack & Barbara Draper 1715 S. Hill Street	Lot 21 Block 24 Rodgersdale	9,564.50	\$ 123.86
Jack & Barbara Draper	Lot 22 Block 24 Rodgersdale	9,564.50	123.86
Jack & Barbara Draper	Lot 23 Block 24 Rodgersdale	9,564.50	123.87
Jack & Barbara Draper	Lot 24 Block 24 Rodgersdale	11,816.04	153.02
Jack & Barbara Draper	Lot 1 Block 25 Rodgersdale	10,427.69	135.04
Jack & Barbara Draper	Lot 2 Block 25 Rodgersdale	9,306	120.51
Jack & Barbara Draper	Lot 3 Block 25 Rodgersdale	9,306	120.52
Jack & Barbara Draper	Lot 4 Block 25 Rodgersdale	9,306	120.51
Jack & Barbara Draper	Lot 5 Block 25 Rodgersdale	9,306	120.52
Jack & Barbara Draper	Lot 6 Block 25 Rodgersdale	9,952.25	128.88
Jack & Barbara Draper	Lot 7 Block 25 Rodgersdale	9,952.25	128.88
Jack & Barbara Draper	Lot 8 Block 25 Rodgersdale	9,306	120.52
Jack & Barbara Draper	Lot 9 Block 25 Rodgersdale	9,306	120.52
Jack & Barbara Draper	Lot 10 Block 25 Rodgersdale	9,306	120.51
Jack & Barbara Draper	Lot 11 Block 25 Rodgersdale	9,306	120.52
Jack & Barbara Draper	Lot 12 Block 25 Rodgersdale	10,544.22	136.55
J. Francyl & Mary B. Howard Box 489	Lot 1 Block 26 Rodgersdale	11,954.81	153.52
J. Francyl & Mary B. Howard	Lot 2 Block 26 Rodgersdale	9,564.50	123.86
J. Francyl & Mary B. Howard	Lot 3 Block 26 Rodgersdale	9,564.50	123.86
J. Francyl & Mary B. Howard	Lot 4 Block 26 Rodgersdale	9,564.50	123.87
J. Francyl & Mary B. Howard	Lot 5 Block 26 Rodgersdale	9,564.50	123.86
J. Francyl & Mary B. Howard	Lot 6 Block 26 Rodgersdale	9,564.50	123.86
J. Francyl & Mary B. Howard	Lot 7 Block 26 Rodgersdale	9,564.50	123.86
J. Francyl & Mary B. Howard	Lot 8 Block 26 Rodgersdale	9,564.50	123.86
J. Francyl & Mary B. Howard	Lot 9 Block 26 Rodgersdale	9,564.50	123.87
J. Francyl & Mary B. Howard	Lot 10 Block 26 Rodgersdale	9,564.50	123.86
Jack & Barbara Draper 1715 S. Hill Street	Lot 11 Block 26 Rodgersdale	9,564.50	123.86
Jack & Barbara Draper	Lot 12 Block 26 Rodgersdale	10,340	133.91
Jack & Barbara Draper	Lot 13 Block 26 Rodgersdale	10,340	133.91
Jack & Barbara Draper	Lot 14 Block 26 Rodgersdale	9,546.50	123.86
Jack & Barbara Draper	Lot 15 Block 26 Rodgersdale	9,564.50	123.86
Jack & Barbara Draper	Lot 16 Block 26 Rodgersdale	9,564.50	123.86
Jack & Barbara Draper	Lot 17 Block 26 Rodgersdale	9,564.50	123.86
Jack & Barbara Draper	Lot 18 Block 26 Rodgersdale	9,564.50	123.86
Jack & Barbara Draper	Lot 19 Block 26 Rodgersdale	9,564.50	123.86
Jack & Barbara Draper	Lot 20 Block 26 Rodgersdale	9,564.50	123.86
Jack & Barbara Draper	Lot 21 Block 26 Rodgersdale	9,564.50	123.87
Jack & Barbara Draper	Lot 22 Block 26 Rodgersdale	9,564.50	123.86
Jack & Barbara Draper	Lot 23 Block 26 Rodgersdale	9,564.50	123.86
Jack & Barbara Draper	Lot 24 Block 26 Rodgersdale	12,042.22	155.95
Jack & Barbara Draper	Lot 1 Block 27 Rodgersdale	12,021.59	155.68

<u>Name of Person on Assessment Roll</u>	<u>Description Of Property</u>	<u>Area Assessed</u>	<u>Amount of Assessment</u>
Jack & Barbara Draper 1715 S. Hill Street	Lot 2 Block 27 Rodgersdale	10,732.35	130.29
Jack & Barbara Draper	Lot 3 Block 27 Rodgersdale	11,576.99	149.92
Jack & Barbara Draper	Lot 4 Block 27 Rodgersdale	12,422.56	160.86
Jack & Barbara Draper	Lot 5 Block 27 Rodgersdale	13,266.16	171.80
Jack & Barbara Draper	Lot 6 Block 27 Rodgersdale	14,110.76	182.74
Jack & Barbara Draper	Lot 7 Block 27 Rodgersdale	14,995.26	193.68
J. Francyl & Mary B. Howard Box 489	Lot 1 Block 28 Rodgersdale	16,396.09	212.33
J. Francyl & Mary B. Howard	Lot 2 Block 28 Rodgersdale	17,200.62	222.75
J. Francyl & Mary B. Howard	Lot 3 Block 28 Rodgersdale	18,065.26	233.95
J. Francyl & Mary B. Howard	Lot 4 Block 28 Rodgersdale	18,909.86	244.89
J. Francyl & Mary B. Howard	Lot 5 Block 28 Rodgersdale	19,734.42	255.57
J. Francyl & Mary B. Howard	Lot 6 Block 28 Rodgersdale	20,579.03	266.50
J. Francyl & Mary B. Howard	Lot 7 Block 28 Rodgersdale	22,423.63	277.44
J. Francyl & Mary B. Howard	Lot 8 Block 28 Rodgersdale	22,268.23	288.38
J. Francyl & Mary B. Howard	Lot 9 Block 28 Rodgersdale	23,112.83	299.32
J. Francyl & Mary B. Howard	Lot 10 Block 28 Rodgersdale	23,957.43	310.25
Jack & Barbara Draper 1715 S. Hill Street	Lot 11 Block 28 Rodgersdale	24,802.03	321.19
Jack & Barbara Draper	Lot 12 Block 28 Rodgersdale	22,091.51	286.09
Jack & Barbara Draper	Lot 1 Block 29 Rodgersdale	11,797.50	152.78
Jack & Barbara Draper	Lot 2 Block 29 Rodgersdale	11,440	148.15
Jack & Barbara Draper	Lot 3 Block 29 Rodgersdale	11,440	148.15
Jack & Barbara Draper	Lot 4 Block 29 Rodgersdale	11,440	148.15
Jack & Barbara Draper	Lot 5 Block 29 Rodgersdale	11,440	148.15
Jack & Barbara Draper	Lot 6 Block 29 Rodgersdale	11,440	148.15
Jack & Barbara Draper	Lot 7 Block 29 Rodgersdale	11,440	148.15
Jack & Barbara Draper	Lot 8 Block 29 Rodgersdale	11,440	148.15
Jack & Barbara Draper	Lot 9 Block 29 Rodgersdale	11,440	148.15
Jack & Barbara Draper	Lot 10 Block 29 Rodgersdale	11,797.50	152.78
Jack & Barbara Draper	Lot 11 Block 29 Rodgersdale	11,797.50	152.78
Jack & Barbara Draper	Lot 12 Block 29 Rodgersdale	11,440	148.15
Jack & Barbara Draper	Lot 13 Block 29 Rodgersdale	11,440	148.15
Jack & Barbara Draper	Lot 14 Block 29 Rodgersdale	11,440	148.15
Jack & Barbara Draper	Lot 15 Block 29 Rodgersdale	11,440	148.15
Jack & Barbara Draper	Lot 16 Block 29 Rodgersdale	11,440	148.15
Jack & Barbara Draper	Lot 17 Block 29 Rodgersdale	11,440	148.15
Jack & Barbara Draper	Lot 18 Block 29 Rodgersdale	11,440	148.15
Jack & Barbara Draper	Lot 19 Block 29 Rodgersdale	11,440	148.15
Jack & Barbara Draper	Lot 20 Block 29 Rodgersdale	11,797.50	152.78
Jack & Barbara Draper	Lot 1 Block 30 Rodgersdale	9,693.75	125.54

<u>Name of Person on Assessment Roll</u>	<u>Description of Property</u>	<u>Area Assessed</u>	<u>Amount of Assessment</u>
Howard & Elma J. Maloney Box 546 Healdsburg, Cal.	Lot 2 Block 30 Rodgersdale	9,435.25	\$ 122.19
Howard & Elma J. Maloney	Lot 3 Block 30 Rodgersdale	9,435.25	122.19
Howard & Elma J. Maloney	Lot 4 Block 30 Rodgersdale	9,435.25	122.19
Floyd D. & Gladys Beers 6601 W. Wapata, Tacoma, Washington	Lot 5 Block 30 Rodgersdale	9,435.25	122.19
Floyd D. & Gladys Beers	Lot 6 Block 30 Rodgersdale	9,435.25	122.19
Jack & Barbara Draper 1715 S. Hill Street	Lot 7 Block 30 Rodgersdale	10,340	133.91
Jack & Barbara Draper	Lot 8 Block 30 Rodgersdale	10,340	133.91
Jack & Barbara Draper	Lot 9 Block 30 Rodgersdale	10,340	133.91
Jack & Barbara Draper	Lot 10 Block 30 Rodgersdale	25,850	334.76
Jack & Barbara Draper	Lot 11 Block 30 Rodgersdale	9,295	120.37
Jack & Barbara Draper	Lot 12 Block 30 Rodgersdale	11,180	144.78
Jack & Barbara Draper	Lot 13 Block 30 Rodgersdale	11,180	144.78
Jack & Barbara Draper	Lot 14 Block 30 Rodgersdale	11,180	144.78
Jack & Barbara Draper	Lot 15 Block 30 Rodgersdale	11,180	144.79
Jack & Barbara Draper	Lot 16 Block 30 Rodgersdale	11,180	144.78
Jack & Barbara Draper	Lot 17 Block 30 Rodgersdale	11,180	144.78
Jack & Barbara Draper	Lot 18 Block 30 Rodgersdale	11,180	144.78
Jack & Barbara Draper	Lot 19 Block 30 Rodgersdale	11,180	144.79
Jack & Barbara Draper	Lot 20 Block 30 Rodgersdale	11,180	144.78
Jack & Barbara Draper	Lot 21 Block 30 Rodgersdale	11,700	151.52
Jack & Barbara Draper	Lot 1 Block 31 Rodgersdale	13,000	168.35
Jack & Barbara Draper	Lot 2 Block 31 Rodgersdale	11,700	151.52
Jack & Barbara Draper	Lot 3 Block 31 Rodgersdale	10,384.62	134.48
Jack & Barbara Draper	Lot 4 Block 31 Rodgersdale	11,682.21	151.29
Jack & Barbara Draper	Lot 5 Block 31 Rodgersdale	11,700	151.52
Jack & Barbara Draper	Lot 6 Block 31 Rodgersdale	13,000	168.35
Jack & Barbara Draper	Lot 1 Block 32 Rodgersdale	13,000	168.35
Jack & Barbara Draper	Lot 2 Block 32 Rodgersdale	11,700	151.52
Jack & Barbara Draper	Lot 3 Block 32 Rodgersdale	13,790.14	178.59
William R. Workman 2931 S. Marion Avenue	Lot 1 Block 1 Ansley Park	6,627.96	85.83
William R. Workman	Lot 2 Block 1 Ansley Park	6,583.12	85.25
William R. Workman	Lot 3 Block 1 Ansley Park	6,566.77	85.04
William R. Workman	Lot 4 Block 1 Ansley Park	6,566.77	85.04
William R. Workman	Lot 5 Block 1 Ansley Park	6,583.12	85.25
William R. Workman	Lot 6 Block 1 Ansley Park	6,627.96	85.83
William R. Workman	Lot 1 Block 2 Ansley Park	5,778.64	74.84
William R. Workman	Lot 2 Block 2 Ansley Park	5,575.02	72.20
William R. Workman	Lot 3 Block 2 Ansley Park	5,521.36	71.75
William R. Workman	Lot 4 Block 2 Ansley Park	5,507.70	71.33

<u>Name of Person on Assessment Roll</u>	<u>Description of Property</u>	<u>Area Assessed</u>	<u>Amount of Assessment</u>
William R. Workman 2931 S. Marion Avenue	Lot 5 Block 2 Ansley Park	5,474.04	\$ 70.89
William R. Workman	Lot 6 Block 2 Ansley Park	5,440.38	70.43
William R. Workman	Lot 7 Block 2 Ansley Park	5,690.29	73.69
William R. Workman	Lot 8 Block 2 Ansley Park	5,690.29	73.69
William R. Workman	Lot 9 Block 2 Ansley Park	5,440.38	70.45
William R. Workman	Lot 10 Block 2 Ansley Park	5,474.04	70.89
William R. Workman	Lot 11 Block 2 Ansley Park	5,507.70	71.33
William R. Workman	Lot 12 Block 2 Ansley Park	5,541.36	71.76
William R. Workman	Lot 13 Block 2 Ansley Park	5,575.02	72.20
William R. Workman	Lot 14 Block 2 Ansley Park	5,778.64	74.83
William R. Workman	Lot 1 Block 3 Ansley Park	5,986.60	77.53
William R. Workman	Lot 2 Block 3 Ansley Park	5,944.42	76.98
William R. Workman	Lot 3 Block 3 Ansley Park	5,902.24	76.44
William R. Workman	Lot 4 Block 3 Ansley Park	6,123.03	79.29
William R. Workman	Lot 5 Block 3 Ansley Park	6,104.03	79.05
William R. Workman	Lot 6 Block 3 Ansley Park	5,902.24	76.44
William R. Workman	Lot 7 Block 3 Ansley Park	5,944.42	76.98
William R. Workman	Lot 8 Block 3 Ansley Park	5,986.60	77.53
William R. Workman	Lot 1 Block 4 Ansley Park	7,600	98.42
William R. Workman	Lot 2 Block 4 Ansley Park	7,600	98.42
William R. Workman	Lot 3 Block 4 Ansley Park	7,634	98.86
William R. Workman	Lot 4 Block 4 Ansley Park	6,918.70	89.60
William R. Workman	Lot 5 Block 4 Ansley Park	6,918.70	89.60
William R. Workman	Lot 6 Block 4 Ansley Park	6,918.70	89.60
William R. Workman	Lot 7 Block 4 Ansley Park	6,958.52	90.10
William R. Workman	Lot 8 Block 4 Ansley Park	7,391.76	95.72
William R. Workman	Lot 9 Block 4 Ansley Park	7,391.76	95.73
William R. Workman	Lot 10 Block 4 Ansley Park	7,424.83	96.15
William R. Workman	Lot 11 Block 4 Ansley Park	6,957.52	90.10
William R. Workman	Lot 12 Block 4 Ansley Park	6,918.70	89.60
William R. Workman	Lot 13 Block 4 Ansley Park	6,918.70	89.60
William R. Workman	Lot 14 Block 4 Ansley Park	7,325.15	94.86
William R. Workman	Lot 1 Block 5 Ansley Park	6,800	88.06
William R. Workman	Lot 2 Block 5 Ansley Park	6,600	85.47
William R. Workman	Lot 3 Block 5 Ansley Park	6,600	85.47
William R. Workman	Lot 4 Block 5 Ansley Park	6,600	85.47
William R. Workman	Lot 5 Block 5 Ansley Park	6,600	85.47
William R. Workman	Lot 6 Block 5 Ansley Park	6,600	85.48
William R. Workman	Lot 7 Block 5 Ansley Park	6,947	89.97
William R. Workman	Lot 8 Block 5 Ansley Park	6,947	89.97
William R. Workman	Lot 9 Block 5 Ansley Park	6,600	85.47
William R. Workman	Lot 10 Block 5 Ansley Park	6,600	85.47
William R. Workman	Lot 11 Block 5 Ansley Park	6,600	85.47

<u>Name of Person on Assessment Roll</u>	<u>Description of Property</u>	<u>Area Assessed</u>	<u>Amount of Assessment</u>
William R. Workman 2931 S. Marion Avenue	Lot 12 Block 5 Ansley Park	6,400	\$ 85.47
William R. Workman	Lot 13 Block 5 Ansley Park	6,600	85.47
William R. Workman	Lot 14 Block 5 Ansley Park	6,800	88.06
William R. Workman	Lot 1 Block 6 Ansley Park	7,400	95.83
William R. Workman	Lot 2 Block 6 Ansley Park	7,400	95.83
William R. Workman	Lot 3 Block 6 Ansley Park	7,400	95.83
William R. Workman	Lot 4 Block 6 Ansley Park	7,665	99.27
William R. Workman	Lot 5 Block 6 Ansley Park	7,645	99.00
William R. Workman	Lot 6 Block 6 Ansley Park	7,400	95.83
William R. Workman	Lot 7 Block 6 Ansley Park	7,400	95.83
William R. Workman	Lot 8 Block 6 Ansley Park	7,400	95.83
William R. Workman	Lot 1 Block 7 Ansley Park	6,631.36	85.88
William R. Workman	Lot 2 Block 7 Ansley Park	6,470.64	83.81
William R. Workman	Lot 3 Block 7 Ansley Park	6,503.64	84.22
William R. Workman	Lot 4 Block 7 Ansley Park	6,570.96	85.10
William R. Workman	Lot 5 Block 7 Ansley Park	6,571.62	85.10
William R. Workman	Lot 6 Block 7 Ansley Park	6,604.62	85.53
William R. Workman	Lot 7 Block 7 Ansley Park	6,987.99	90.50
William R. Workman	Lot 8 Block 7 Ansley Park	6,987.99	90.50
William R. Workman	Lot 9 Block 7 Ansley Park	6,604.62	85.53
William R. Workman	Lot 10 Block 7 Ansley Park	6,604.62	85.53
William R. Workman	Lot 11 Block 7 Ansley Park	6,570.66	85.09
William R. Workman	Lot 12 Block 7 Ansley Park	6,503.64	84.22
William R. Workman	Lot 13 Block 7 Ansley Park	6,470.64	83.80
William R. Workman	Lot 14 Block 7 Ansley Park	6,436.32	83.35
William R. Workman	School Park Block Ansley Park	76,006.13	984.30
William R. Workman	Area Bounded by 28th & 30th, R. R. St. & Marion St.	84,330.40	1,092.10
Jack & Barbara Draper 1715 S. Hill Street	S. 75' of an area bounded by 27th, 28th, R. R. St. & Marion St.	14,374.50	186.15
Eilert & Rosa Meling 2809 S. Marion St.	N. 25' of an area bounded by 27th, 28th, R. R. St. & Marion St.	23,957.50	310.25
GRAND TOTALS		8,420,828.37	\$109,051.61

South Residential Storm Sewer Trunk
Assessment Boundary

Assessment Boundary

Assessment Boundaries

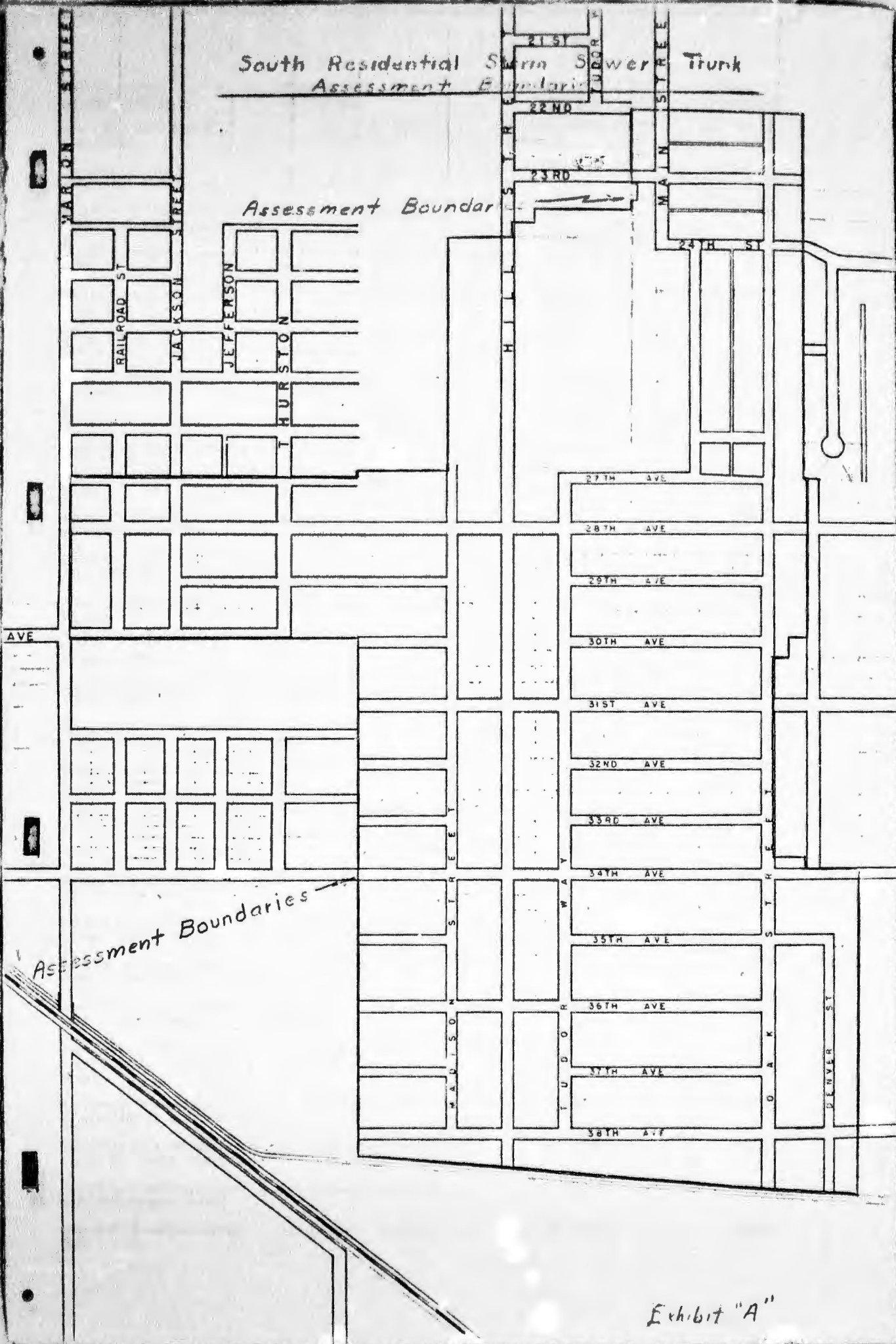

Exhibit "A"

<u>Name of Person on Assessment Roll</u>	<u>Description of Property</u>	<u>Area</u>	<u>Amount of Assessment</u>
Leroy W. Goven 2225 S. Main Street	W. 77.47' of E. 200' Lot 1 Morningside Trs.	15,494.0	\$ 219.69
Harold W. & Phyllis A. Agnew 2810 Park Terrace	S. 76' of W. 200' Lot 1 Morningside Trs.	15,200.0	215.46
Robert F. & LaDona Louise Daly 2430 Denver Place	E. 50' Lot 1 Morningside Trs.	7,573.5	108.77
Robert F. & LaDona Louise Daly	W. 10' of E. 30' Lot 2 Morningside Trs.	1,363.2	19.32
Milton B. & Erika L. Hall P. O. Box 148	W. 120 Lot 2 Morningside Trs.	16,358.4	231.88
Verna Miller 1115 E. 23rd Avenue	W. 100' of E. 130' Lot 2 Morningside Trs.	13,632.0	193.24
Robert & Arlene Dahl 1925 Willamette St.	E. 20' Lot 2 Morningside Trs.	2,726.4	38.65
Robert & Arlene Dahl	W. 50' Lot 3 Morningside Trs.	6,816.0	96.62
Erman K. & Erma E. Johnston 2210 Geary St.	E. 150' Lot 3 Morningside Trs.	20,448.0	289.85
Erman K. & Erma E. Johnston	E. 150' Lot 4 Morningside Trs.	23,020.5	326.32
Robert F. & LaDona Louise Daly 2430 Denver Place	W. 50' Lot 4 Morningside Trs.	7,673.5	108.77
Erman K. & Erma E. Johnston 2210 Geary St.	Lot 5 Morningside Trs.	40,606.55	575.61
Frank Sloan & Virginia Dannals 1110 E. 23rd Ave.	W. 95' Lot 6 Morningside Trs.	12,712.9	180.21
Frank & Aileen Block 1130 E. 23rd Avenue	E. 25' Lot 6 Morningside Trs.	3,345.5	47.42
Harold & Dorothy Ann Jackson 1120 E. 23rd Ave.	E. 80' of W. 175' Lot 6 Morning- side Trs.	10,705.6	151.75
Clyde M. & Carolyn Rogers 1115 E. 24th Avenue	E. 75' of W. 155' Lot 7 Morning- side Trs.	10,036.5	142.27
Gene & Barbara E. Asai 1105 E. 24th Avenue	W. 80' Lot 7 Morningside Trs.	10,705.6	151.75
Glenn L. & Ada Lou Galloway 1125 E. 24th Avenue	E. 45' Lot 7 Morningside Trs.	6,021.9	85.36
Glenn L. & Ada Lou Galloway	W. 55' Lot 8 Morningside Trs.	7,360.1	104.33
Robert W. & LaVada Erner 1135 E. 24th Avenue	W. 95' of E. 195' Lot 8 Morning- side Trs.	12,712.9	180.21
Forrest D. & Bertha L. Liddle 2340 S. Oak St.	E. 100' Lot 8 Morningside Trs.	13,382.0	189.69
Frank E. & Aileen Block 1130 E. 23rd Avenue	W. 45' Lot 9 Morningside Trs.	6,021.9	85.36
Kenneth A. & Zella Perfect 1140 E. 23rd Avenue	E. 70' of W. 115' Lot 9 Morning- side Trs.	9,367.4	132.78
William R. & Gracia L. Jor- dan 169 Bodie St., Roseburg, Oregon	W. 70' of E. 135' Lot 9 Morning- side Trs.	9,367.4	132.78
William T. & Catherine W. Peters 1160 E. 23rd Ave.	E. 65' of Lot 9 Morningside Trs.	8,698.3	123.30
Scharpf's Twin Oak Builders Supply Co. 760 E. 2nd Ave.	Lot 10 Morningside Trs.	37,481.4	531.31
Robert F. & LaDona Louise Daly 2430 Denver Place	Lot 11 Morningside Trs.	26,604.78	377.13
Robert F. & LaDona Louise Daly	Lot 12 Morningside Trs.	28,647.65	406.09

<u>Name of Person on Assessment Roll</u>	<u>Description of Property</u>	<u>Area Assessed</u>	<u>Amount of Assessment</u>
Robert F. & LaDona Louise Daly 2430 Denver Place	Lot 13 Morningside Trs.	28,647.65	\$ 406.09
Robert F. & LaDona Louise Daly	Lot 14 Morningside Trs.	31,611	448.09
Jack C. & Alexa C. Utter- back 2005 W. 5th Avenue	E. 74.83' of S. 68.16' also 7.62' strip adj. on East Daly & Kelly Supp. H llywood Acres Lot 1 Block 21	5,619.79	79.66
Lyle & Ardyce Housar 220 S. Main Street	Also 7.62' strip adj. on East Lot 2 Block 21 Daly & Kelly Supp. Plat to Hollywood Acres	5,807.23	82.32
Scharpf's T/in Oak Builders Supply Co. 760 E. 2nd Ave.	Also 7.62' strip adj. on East Lot 3 Block 21 Daly & Kelly Supp. Plat to Hollywood Acres	6,073.06	86.09
Scharpf's Twin Oak Builders Supply Co.	Ex. S. 11.24'; Also 7.62' strip adj. on East Lot 4 Block 21 Daly & Kelly Supp. Plat to Hollywood Acres	5,967.61	84.59
Harold W. & Bessie L. Pollock 814 Charnelton Street Eugene, Oregon	S. 22.52' of E. 59.98' also 7.62' strip adj. on East Lot 5 Block 21 Daly & Kelly Supp. Plat to H llywood Acres	1,521.00	21.56
Harold W. & Bessie L. Pollock	E. 59.98' also 7.62' scrip on E. Lot 6 Block 21 Daly & Kelly Supp. Plat to Hollywood Acres	4,818.53	68.30
Harold W. & Bessie L. Pollock	N. 6.20' of E. 59.98' also 7.62' strip adj. on East Lot 7 Block 21 Daly & Kelly Supp. Plat to Holly- wood	419.12	5.94
John A. & Margaret E. Boock 532 W. 7th Avenue	Ex. N. 6.20' also 7.62' strip adj. on East Lot 7 Block 21 Daly & Kelly Supp. Plat to Hollywood Acres	5,544.82	78.60
John A. & Margaret E. Boock	7.62' strip adj. on E. Lot 8 Block 21 Daly & Kelly Supp. Plat to Hollywood Acres	6,073.06	86.08
John A. & Margaret E. Boock	Also 7.62' strip adj. on East Lot 9 Block 21 Daly & Kelly Supp. Plat to Hollywood Acres	6,073.06	86.08
Robert F. & LaDona Louise Daly & Orris L. & Jewel A. Bowman 330 N. Harrison St.	Lot 1 So. Add. to Morningside Tracts	31,524	446.86
Robert F. & LaDona Louise Daly & Orris L. & Jewel A. Bowman 330 N. Harrison St.	N. 175' Lot 2 So. Add. to Morning- side Tracts	27,583.5	391.00
Norman D. & Elaine N. Cahill 2540 S. Main St.	S. 50' Lot 2 So. Add. to Morning- side Tracts	7,881.0	111.72
Norman D. & Elaine N. Cahill	N. 25' Lot 3 So. Add. to Morning- side Tracts	3,940.5	55.86
Luella M. Harman 721 N. 17th St., Corvallis, Ore.	S. 175' Lot 3 So. Add. to Morning- side Tracts	27,583.5	391.00
Luella M. Herman	N. 5' Lot 4 So. Add. to Morning- side Tracts	788.1	11.17
Robert F. & LaDona Louise Daly & Orris L. & Jewel A. Bowman 330 N. Harrison St.	S. 214.35' Lot 4 So. Add. to Morningside Tracts	33,792.28	479.01
Robert F. & LaDona Louise Daly & Orris L. & Jewel A. Bowman	Lot 5 So. Add. to Morningside Tracts	24,044.5	340.84
Robert F. & LaDona Louise Daly & Orris L. & Jewel A. Bowman	Lot 6 So. Add. to Morningside Tracts	24,933.91	353.44

<u>Name of Person on Assessment Roll</u>	<u>Description of Property</u>	<u>Area Assessed</u>	<u>Amount of Assessment</u>
Robert F. & LaDona Louise Daly & Orris L. & Jewel A. Bowman 330 N. Harrison St.	Lot 7 So. Add. to Morningside Tracts	30,958.5	\$ 438.84
Robert F. & LaDona Louise Daly & Orris L. & Jewel A. Bowman	Lot 8 So. Add. to Morningside Tracts	26,794.0	379.81
Robert F. & LaDona Louise Daly & Orris L. & Jewel A. Bowman	Lot 9 So. Add. to Morningside Tracts	30,195	428.02
Robert F. & LaDona Louise Daly & Orris L. & Jewel A. Bowman	Lot 10 So. Add. to Morningside Tracts	26,888	381.14
Robert F. & LaDona Louise Daly & Orris L. & Jewel A. Bowman	Lot 11 So. Add. to Morningside Tracts	29,000	411.08
Robert F. & LaDona Louise Daly & Orris L. & Jewel A. Bowman	Lot 12 So. Add. to Morningside Tracts	29,000	411.08
Robert F. & LaDona Louise Daly & Orris L. & Jewel A. Bowman	Lot 13 So. Add. to Morningside Tracts	32,625	462.47
Robert F. & LaDona Louise Daly & Orris L. & Jewel A. Bowman	Lot 14 So. Add. to Morningside Tracts	32,625	462.47
Robert F. & LaDona Louise Daly & Orris L. & Jewel A. Bowman	Lot 15 So. Add. to Morningside Tracts	36,250	513.85
Robert F. & LaDona Louise Daly & Orris L. & Jewel A. Bowman	Lot 16 So. Add. to Morningside Tracts	36,250	513.85
John A. & Margaret E. Boock 532 W. 7th Avenue	Lot 11 Block 16 Daly & Kelly Supp. Hollywood Acres	5,670.1	80.37
John A. & Margaret E. Boock 532 W. 7th Avenue	Lot 12 Block 16 Daly & Kelly Supp. Hollywood Acres	5,670.1	80.37
John A. & Margaret E. Boock	Lot 13 Block 16 Daly & Kelly Supp. Hollywood Acres	8,745.66	123.97
John A. & Margaret E. Boock	Lot 14 Block 16 Daly & Kelly Supp. Hollywood Acres	8,745.66	123.97
John A. & Margaret E. Boock	Lot 15 Block 16 Daly & Kelly Supp. Hollywood Acres	8,745.66	123.97
John A. & Margaret E. Boock	Lot 16 Block 16 Daly & Kelly Supp. Hollywood Acres	8,745.66	123.97
John A. & Margaret E. Boock	Lot 17 Block 16 Daly & Kelly Supp. Hollywood Acres	8,745.66	123.97
John A. & Margaret E. Boock	Lot 18 Block 16 Daly & Kelly Supp. Hollywood Acres	8,745.66	123.97
John A. & Margaret E. Boock	Lot 20 Block 16 Daly & Kelly Supp. Hollywood Acres	6,941.00	98.39
John A. & Margaret E. Boock	(Vacated Street) Block 16 Daly & Kelly Supp. Hollywood Acres	4,164.60	59.03
H. L. & Hazel Fair Rt. 2 Box 392	Block 10 S $\frac{1}{2}$ Hollywood Acres	43,560.52	617.48
Charles & Ratta Mae Draper 1715 S. Hill Street	N $\frac{1}{2}$ of Blk. 10, Ex. N. 20' of E. 130.95' & the N. 166.325' of W. 130.95' Block 10 Hollywood Acres	19,161.26	271.61
Floyd H. & Shirley R. Goin 2400 S. Hill Street	N. 20' of E. 130.95' & N. 166.325' of W. 130.95'	24,399.26	345.86
Owen & Mary C. Beam 225 W. 2nd Avenue	Block 11 Hollywood Acres	87,121.04	1,234.96

<u>Name of Person on Assessment Roll</u>	<u>Description of Property</u>	<u>Area Assessed</u>	<u>Amount of Assessment</u>
John A. & Margaret E. Boock 532 W. 7th Avenue	Block 12 Hollywood Acres	103,660.02	\$1,469.40
Owen & Mary G. Beam 225 W. 2nd Avenue	Block 13 Hollywood Acres	131,480.64	1,863.76
Laird & Jereise M. Hyde 2755 S. Hill Street	5½ Ex. W. 200' of N. 136.25' Block 14 Hollywood Acres	16,310.52	231.21
Jack & Barbara Draper 1715 S. Hill Street	W. 200' of N. 136.25' of S½ of Tr. ¼ Block 14 Hollywood Acres	27,250.0	386.27
Owen & Mary G. Beam 225 W. 2nd Avenue	N½ Block 14 Hollywood Acres	43,560.52 771,156	617.48
Owen & Mary G. Beam	Ex. N. 20' Block 15 Holly- wood Acres	77,697.55	1,101.38
J. L. Rodgers 341 E. 4th Avenue	Lot 7 Block 1 2nd Add. to Rodgers Acres	7,500.0	106.31
Jack & Barbara Draper 1715 S. Hill Street	Lot 8 Block 1 2nd Add. to Rodgers Acres	7,500.0	106.31
Jack & Barbara Draper	Lot 9 Block 1 2nd Add. to Rodgers Acres	7,500.0	106.32
Jack & Barbara Draper 1715 S. Hill Street	Lot 10 Block 1 2nd Add. to Rodgers Acres	7,500.0	106.31
Jack & Barbara Draper	Lot 11 Block 1 2nd Add. to Rodgers Acres	7,500.0	106.32
Jack & Barbara Draper	Lot 12 Block 1 2nd Add. to Rodgers Acres	7,128.0	101.04
J. L. Rodgers 341 E. 4th Avenue	Lot 2 Block 2 2nd Add. to Rodgers Acres	8,396.78	119.03
J. L. Rodgers	Lot 4 Block 2 2nd Add. to Rodgers Acres	7,950.0	112.69
J. L. Rodgers	Lot 5 Block 2 2nd Add. to Rodgers Acres	7,100.0	100.64
Jack & Barbara Draper 1715 S. Hill Street	Lot 6 Block 2 2nd Add. to Rodgers Acres	7,000	99.23
Jack & Barbara Draper	Lot 7 Block 2 2nd Add. to Rodgers Acres	7,100.0	100.64
J. L. Rodgers 341 E. 4th Avenue	Lot 1 Block 3 2nd Add. to Rodgers Acres	8,040.56	113.98
J. L. Rodgers	Lot 2 Block 3 2nd Add. to Rodgers Acres	7,726.24	109.53
J. L. Rodgers	Lot 3 Block 3 2nd Add. to Rodgers Acres	7,950.0	112.69
J. L. Rodgers	Lot 4 Block 3 2nd Add. to Rodgers Acres	7,950.0	112.69
J. L. Rodgers	Lot 5 Block 3 2nd Add. to Rodgers Acres	7,100.0	100.64
J. L. Rodgers	Lot 6 Block 3 2nd Add. to Rodgers Acres	7,000.0	99.23
J. L. Rodgers	Lot 7 Block 3 2nd Add. to Rodgers Acres	7,100.0	100.64
J. L. Rodgers	Lot 1 Block 4 2nd Add. to Rodgers Acres	6,603.30	93.60
J. L. Rodgers	Lot 2 Block 4 2nd Add. to Rodgers Acres	6,300.0	89.31
J. L. Rodgers	Lot 3 Block 4 2nd Add. to Rodgers Acres	6,300.0	89.30

<u>Name of Person on Assessment Roll</u>	<u>Description of Property</u>	<u>Area Assessed</u>	<u>Amount of Assessment</u>
J. L. Rodgers 341 E. 4th Avenue	Lot 4 Block 4 2nd Add. to Rodgers Acres	6,300.0	\$ 89.31
J. L. Rodgers	Lot 5 Block 4 2nd Add. to Rodgers Acres	6,300.0	89.30
J. L. Rodgers	Lot 6 Block 4 2nd Add. to Rodgers Acres	6,300.0	89.31
J. L. Rodgers	Lot 7 Block 4 2nd Add. to Rodgers Acres	6,300.0	89.30
J. L. Rodgers	Lot 8 Block 4 2nd Add. to Rodgers Acres	6,300.0	89.31
J. L. Rodgers	Lot 9 Block 4 2nd Add. to Rodgers Acres	6,300.0	89.30
J. L. Rodgers	Lot 10 Block 4 2nd Add. to Rodgers Acres	6,300.0	89.31
J. L. Rodgers	Lot 11 Block 4 2nd Add. to Rodgers Acres	6,300.0	89.30
J. L. Rodgers	Lot 12 Block 4 2nd Add. to Rodgers Acres	6,300.0	89.30
J. L. Rodgers	Lot 13 Block 4 2nd Add. to Rodgers Acres	6,480.0	91.86
J. L. Rodgers	Lot 14 Block 4 2nd Add. to Rodgers Acres	6,480.0	91.86
J. L. Rodgers	Lot 15 Block 4 2nd Add. to Rodgers Acres	6,300.0	89.30
J. L. Rodgers	Lot 16 Block 4 2nd Add. to Rodgers Acres	6,300.0	89.30
J. L. Rodgers	Lot 17 Block 4 2nd Add. to Rodgers Acres	6,300.0	89.30
J. L. Rodgers	Lot 18 Block 4 2nd Add. to Rodgers Acres	6,300.0	89.30
J. L. Rodgers	Lot 19 Block 4 2nd Add. to Rodgers Acres	6,300.0	89.30
J. L. Rodgers	Lot 20 Block 4 2nd Add. to Rodgers Acres	6,300.0	89.30
J. L. Rodgers	Lot 21 Block 4 2nd Add. to Rodgers Acres	6,300.0	89.30
J. L. Rodgers	Lot 22 Block 4 2nd Add. to Rodgers Acres	6,300.0	89.30
J. L. Rodgers	Lot 23 Block 4 2nd Add. to Rodgers Acres	6,300.0	89.30
J. L. Rodgers	Lot 24 Block 4 2nd Add. to Rodgers Acres	6,300.0	89.31
J. L. Rodgers	Lot 25 Block 4 2nd Add. to Rodgers Acres	6,300.0	89.31
J. L. Rodgers	Lot 26 Block 4 2nd Add. to Rodgers Acres	6,652.80	94.31
Scharpf's Twin Oak Builders Supply Co. 760 E. 2nd Ave.	Lot 1 Block 5 2nd Add. to Rodgers Acres	7,169.0	101.62
Scharpf's Twin Oak Builders Supply Co.	Lot 2 Block 5 2nd Add. to Rodgers Acres	7,500.0	106.31
Scharpf's Twin Oak Builders Supply Co.	Lot 3 Block 5 2nd Add. to Rodgers Acres	7,500.0	106.32
Scharpf's Twin Oak Builders Supply Co.	Lot 4 Block 5 2nd Add. to Rodgers Acres	7,500.0	106.31
Scharpf's Twin Oak Builders Supply Co.	Lot 5 Block 5 2nd Add. to Rodgers Acres	7,500.0	106.31

<u>Name of Person on Assessment Roll</u>	<u>Description of Property</u>	<u>Area Assessed</u>	<u>Amount of Assessment</u>
Jack & Barbara Draper 1715 S. Hill Street	Lot 6 Block 5 2nd Add. to Rodgers Acres	7,500.0	\$ 106.31
Howard & Elna J. Maloney Box 546 Healdsburg, Cal.	Lot 7 Block 5 2nd Add. to Rodgers Acres	7,500.0	106.32
Jack & Barbara Draper 1715 S. Hill Street	Lot 1 Block 6 2nd Add. to Rodgers Acres	7,100.0	100.64
Jack & Barbara Draper	Lot 2 Block 6 2nd Add. to Rodgers Acres	7,000.0	99.23
J. L. Rodgers 341 E. 4th Avenue	Lot 3 Block 6 2nd Add. to Rodgers Acres	7,100.0	100.64
J. L. Rodgers	Lot 4 Block 6 2nd Add. to Rodgers Acres	7,950.0	112.69
Jack & Barbara Draper 1715 S. Hill Street	Lot 5 Block 6 2nd Add. to Rodgers Acres	7,950.0	112.69
J. L. Rodgers 341 E. 4th Avenue	Lot 1 Block 7 2nd Add. to Rodgers Acres	7,100.0	100.64
Howard L. & Elna J. Maloney Box 546, Healdsburg, Cal.	Lot 2 Block 7 2nd Add. to Rodgers Acres	7,000.0	99.23
Howard L. & Elna J. Maloney	Lot 3 Block 7 2nd Add. to Rodgers Acres	7,100.0	100.64
Howard L. & Elna J. Maloney	Lot 4 Block 7 2nd Add. to Rodgers Acres	7,950.0	112.69
J. L. Rodgers 341 E. 4th Avenue	Lot 5 Block 7 2nd Add. to Rodgers Acres	7,950.0	112.69
J. L. Rodgers	Lot 1 Block 8 2nd Add. to Rodgers Acres	7,485.0	106.12
J. L. Rodgers	Lot 2 Block 8 2nd Add. to Rodgers Acres	7,000.0	99.23
J. L. Rodgers	Lot 3 Block 8 2nd Add. to Rodgers Acres	7,000.0	99.23
J. L. Rodgers	Lot 4 Block 8 2nd Add. to Rodgers Acres	7,000.0	99.23
J. L. Rodgers	Lot 5 Block 8 2nd Add. to Rodgers Acres	7,000.0	99.23
J. L. Rodgers	Lot 6 Block 8 2nd Add. to Rodgers Acres	7,000.0	99.23
J. L. Rodgers	Lot 7 Block 8 2nd Add. to Rodgers Acres	7,000.0	99.22
J. L. Rodgers	Lot 8 Block 8 2nd Add. to Rodgers Acres	7,000.0	99.23
J. L. Rodgers	Lot 9 Block 8 2nd Add. to Rodgers Acres	7,000.0	99.22
J. L. Rodgers	Lot 10 Block 8 2nd Add. to Rodgers Acres	7,000.0	99.23
J. L. Rodgers	Lot 11 Block 8 2nd Add. to Rodgers Acres	7,000.0	99.22
J. L. Rodgers	Lot 12 Block 8 2nd Add. to Rodgers Acres	7,000.0	99.23
J. L. Rodgers	Lot 13 Block 8 2nd Add. to Rodgers Acres	7,200.0	102.06
Laird & Jerelee Hyde 2755 S. Hill Street	Lot 14 Block 8 2nd Add. to Rodgers Acres	7,200.0	102.06
Laird & Jerelee Hyde	Lot 15 Block 8 2nd Add. to Rodgers Acres	7,000.0	99.22
Laird & Jerelee Hyde	Lot 16 Block 8 2nd Add. to Rodgers Acres	7,000.0	99.23

<u>Name of Person on Assessment Roll</u>	<u>Description of Property</u>	<u>Area Assessed</u>	<u>Amount of Assessment</u>
Laird & Jerelee Hyde 2755 S. Hill Street	Lot 17 Block 8 2nd Add. to Rodgers Acres	7,000.0	\$ 99.22
Laird & Jerelee Hyde	Lot 18 Block 8 2nd Add. to Rodgers Acres	7,000.0	99.23
Laird & Jerelee Hyde	Lot 19 Block 8 2nd Add. to Rodgers Acres	7,000.0	99.22
Howard & Elma J. Maloney Box 546 Healdsburg, Cal.	Lot 20 Block 8 2nd Add. to Rodgers Acres	7,000.0	99.23
Jack & Barbara Draper 1715 S. Hill Street	Lot 21 Block 8 2nd Add. to Rodgers Acres	7,000.0	99.22
Jack & Barbara Draper	Lot 22 Block 8 2nd Add. to Rodgers Acres	7,000.0	99.23
Jack & Barbara Draper	Lot 23 Block 8 2nd Add. to Rodgers Acres	7,000.0	99.23
Jack & Barbara Draper	Lot 24 Block 8 2nd Add. to Rodgers Acres	7,000.0	99.23
Jack & Barbara Draper	Lot 25 Block 8 2nd Add. to Rodgers Acres	7,000.0	99.23
Jack & Barbara Draper	Lot 26 Block 8 2nd Add. to Rodgers Acres	7,547.0	106.98
Jack & Barbara Draper	Lot 18 1st Add. to Rodgers Acres	21,976.64	311.52
Jack & Barbara Draper	Lot 19 1st Add. to Rodgers Acres	19,000.0	269.33
Jack & Barbara Draper	Lot 20 1st Add. to Rodgers Acres	19,000.0	269.33
Jack & Barbara Draper	Lot 21 1st Add. to Rodgers Acres	19,000.0	269.32
Jack & Barbara Draper	Lot 22 1st Add. to Rodgers Acres	19,000.0	269.33
Jack & Barbara Draper	Lot 23 1st Add. to Rodgers Acres	19,000.0	269.33
Jack & Barbara Draper	Lot 24 1st Add. to Rodgers Acres	19,000.0	269.32
M. Wayne & Maybelle Goin 3110 S. Marion Street	W. 90' Lot 25 1st Add. to Rodgers Acres	9,000.0	127.56
Jack & Barbara Draper 1715 S. Hill Street	Lot 6 Block 1 Rodgersdale	9,625.0	136.44
Jack & Barbara Draper	Lot 7 Block 1 Rodgersdale	9,625.0	136.43
Charles & Retta Mae Draper 1715 S. Hill Street	Lot 1 Block 2 Rodgersdale	8,162.0	115.70
Charles & Retta Mae Draper	Lot 2 Block 2 Rodgersdale	8,162.0	115.69
Charles & Retta Mae Draper	Lot 3 Block 2 Rodgersdale	8,162.0	115.70
Charles & Retta Mae Draper	Lot 4 Block 2 Rodgersdale	8,162.0	115.70
Charles & Retta Mae Draper	Lot 5 Block 2 Rodgersdale	8,162.0	115.70
Charles & Retta Mae Draper	Lot 6 Block 2 Rodgersdale	8,162.0	115.70
Charles & Retta Mae Draper	Lot 7 Block 2 Rodgersdale	8,162.0	115.70
Charles & Retta Mae Draper	Lot 8 Block 2 Rodgersdale	9,116.0	129.22
William M. & Patricia M. Stratton 542 University Healdsburg, California	Lot 9 Block 2 Rodgersdale	9,116.0	129.22
William M. & Patricia M. Stratton	Lot 10 Block 2 Rodgersdale	8,162.0	115.70
Charles & Retta Mae Draper 1715 S. Hill Street	Lot 11 Block 2 Rodgersdale	8,162.0	115.70
Charles & Retta Mae Draper	Lot 12 Block 2 Rodgersdale	8,162.0	115.70
Charles & Retta Mae Draper	Lot 13 Block 2 Rodgersdale	8,162.0	115.70

<u>Name of Person on Assessment Roll</u>	<u>Description of Property</u>	<u>Area Assessed</u>	<u>Amount of Assessment</u>
Charles & Retta Mae Draper 1715 S. Hill Street	Lot 14 Block 2 Rodgersdale	8,162.0	\$ 115.70
Charles & Retta Mae Draper	Lot 15 Block 2 Rodgersdale	8,162.0	115.70
Charles & Retta Mae Draper	Lot 16 Block 2 Rodgersdale	8,162.0	115.70
William M. & Patricia M. Stratton 342 University Healdsburg, California	Lot 1 Block 3 Rodgersdale	8,162.0	113.70
William M. & Patricia M. Stratton	Lot 2 Block 3 Rodgersdale	8,162.0	115.70
William M. & Patricia M. Stratton	Lot 3 Block 3 Rodgersdale	8,162.0	115.70
William M. & Patricia M. Stratton	Lot 4 Block 3 Rodgersdale	8,162.0	115.70
William M. & Patricia M. Stratton	Lot 5 Block 3 Rodgersdale	8,162.0	115.70
William M. & Patricia M. Stratton	Lot 6 Block 3 Rodgersdale	8,162.0	115.69
William M. & Patricia M. Stratton	Lot 7 Block 3 Rodgersdale	8,162.0	115.69
William M. & Patricia M. Stratton	Lot 8 Block 3 Rodgersdale	9,116.0	129.22
Charles & Retta Mae Draper 1715 S. Hill Street	Lot 9 Block 3 Rodgersdale	9,116.0	129.22
Charles & Retta Mae Draper	Lot 10 Block 3 Rodgersdale	8,162.0	115.69
Jack & Barbara Draper 1715 S. Hill Street	Lot 11 Block 3 Rodgersdale	8,162.0	115.70
Jack & Barbara Draper	Lot 12 Block 3 Rodgersdale	8,162.0	115.70
Jack & Barbara Draper	Lot 13 Block 3 Rodgersdale	8,162.0	115.70
Jack & Barbara Draper	Lot 14 Block 3 Rodgersdale	8,162.0	115.70
Jack & Barbara Draper	Lot 15 Block 3 Rodgersdale	8,162.0	115.70
Jack & Barbara Draper	Lot 16 Block 3 Rodgersdale	8,162.0	115.69
Jack & Barbara Draper	Lot 1 Block 4 Rodgersdale	9,806.25	139.01
Jack & Barbara Draper	Lot 2 Block 4 Rodgersdale	9,250.0	131.12
Jack & Barbara Draper	Lot 3 Block 4 Rodgersdale	9,250.0	131.12
Jack & Barbara Draper	Lot 4 Block 4 Rodgersdale	9,250.0	131.12
Jack & Barbara Draper	Lot 5 Block 4 Rodgersdale	9,250.0	131.12
Jack & Barbara Draper	Lot 6 Block 4 Rodgersdale	9,250.0	131.12
Jack & Barbara Draper	Lot 7 Block 4 Rodgersdale	9,250.0	131.12
Jack & Barbara Draper	Lot 8 Block 4 Rodgersdale	9,250.0	131.12
Jack & Barbara Draper	Lot 9 Block 4 Rodgersdale	9,250.0	131.12
Jack & Barbara Draper	Lot 10 Block 4 Rodgersdale	9,250.0	131.12
Jack & Barbara Draper	Lot 11 Block 4 Rodgersdale	9,250.0	131.12
Jack & Barbara Draper	Lot 12 Block 4 Rodgersdale	10,000.0	141.75
Jack & Barbara Draper	Lot 13 Block 4 Rodgersdale	10,000.0	141.75
Jack & Barbara Draper	Lot 14 Block 4 Rodgersdale	9,250.0	131.12
Jack & Barbara Draper	Lot 15 Block 4 Rodgersdale	9,250.0	131.12
Jack & Barbara Draper	Lot 16 Block 4 Rodgersdale	9,250.0	131.12
Jack & Barbara Draper	Lot 17 Block 4 Rodgersdale	9,250.0	131.12

<u>Name of Person on Assessment Roll</u>	<u>Description of Property</u>	<u>Area Assessed</u>	<u>Amount of Assessment</u>
Jack & Barbara Draper 1717 S. Hill Street	Lot 18 Block 4 Rodgersdale	9,250.0	\$ 131.12
Jack & Barbara Draper	Lot 19 Block 4 Rodgersdale	9,250.0	131.12
Jack & Barbara Draper	Lot 20 Block 4 Rodgersdale	9,250.0	131.12
Jack & Barbara Draper	Lot 21 Block 4 Rodgersdale	9,250.0	131.12
Jack & Barbara Draper	Lot 22 Block 4 Rodgersdale	9,250.0	131.12
Jack & Barbara Draper	Lot 23 Block 4 Rodgersdale	9,250.0	131.12
Jack & Barbara Draper	Lot 24 Block 4 Rodgersdale	9,922.5	140.66
Jack & Barbara Draper	Block 5 Rodgersdale E. 77'	19,250	272.87
Jack & Barbara Draper	Lot 1 Block 6 Rodgersdale	10,023.75	142.09
Jack & Barbara Draper	Lot 2 Block 6 Rodgersdale	9,250.0	131.12
Jack & Barbara Draper	Lot 3 Block 6 Rodgersdale	9,250.0	131.12
Jack & Barbara Draper	Lot 4 Block 6 Rodgersdale	9,250.0	131.12
Jack & Barbara Draper	Lot 5 Block 6 Rodgersdale	9,250.0	131.12
Jack & Barbara Draper	Lot 6 Block 6 Rodgersdale	9,250.0	131.12
Jack & Barbara Draper	Lot 7 Block 6 Rodgersdale	9,250.0	131.12
Jack & Barbara Draper	Lot 8 Block 6 Rodgersdale	9,250.0	131.12
Jack & Barbara Draper	Lot 9 Block 6 Rodgersdale	9,250.0	131.12
Jack & Barbara Draper	Lot 10 Block 6 Rodgersdale	9,250.0	131.12
Jack & Barbara Draper	Lot 11 Block 6 Rodgersdale	9,250.0	131.12
Jack & Barbara Draper	Lot 12 Block 6 Rodgersdale	10,000.0	141.75
Jack & Barbara Draper	Lot 13 Block 6 Rodgersdale	10,000.0	141.75
Jack & Barbara Draper	Lot 14 Block 6 Rodgersdale	9,250.0	131.12
Jack & Barbara Draper	Lot 15 Block 6 Rodgersdale	9,250.0	131.12
Jack & Barbara Draper	Lot 16 Block 6 Rodgersdale	9,250.0	131.12
Jack & Barbara Draper	Lot 17 Block 6 Rodgersdale	9,250.0	131.12
Jack & Barbara Draper	Lot 18 Block 6 Rodgersdale	9,250.0	131.12
Jack & Barbara Draper	Lot 19 Block 6 Rodgersdale	9,250.0	131.13
Jack & Barbara Draper	Lot 20 Block 6 Rodgersdale	9,250.0	131.12
Jack & Barbara Draper	Lot 21 Block 6 Rodgersdale	9,250.0	131.12
Jack & Barbara Draper	Lot 22 Block 6 Rodgersdale	9,250.0	131.12
Jack & Barbara Draper	Lot 23 Block 6 Rodgersdale	9,250.0	131.12
Jack & Barbara Draper	Lot 24 Block 6 Rodgersdale	10,116.25	143.40
Jack & Barbara Draper	Lot 1 Block 8 Rodgersdale	8,291.32	117.53
Jack & Barbara Draper	Lot 20 Block 8 Rodgersdale	8,291.32	117.53
Jack & Barbara Draper	Lot 1 Block 9 Rodgersdale	8,291.32	117.53
Jack & Barbara Draper	Lot 20 Block 9 Rodgersdale	8,291.32	117.53
J. Francyl & Mary B. Howard P. O. Box 489	Lot 1 Block 10 Rodgersdale	9,015.6	127.80
J. Francyl & Mary B. Howard	Lot 2 Block 10 Rodgersdale	8,140.0	115.39
J. Francyl & Mary B. Howard	Lot 3 Block 10 Rodgersdale	8,140.0	115.38

<u>Name of Person on Assessment Roll</u>	<u>Description of Property</u>	<u>Area Assessed</u>	<u>Amount of Assessment</u>
J. Francyl & Mary B. Howard P. O. Box 489	Lot 4 Block 10 Rodgersdale	8,140.0	\$ 115.39
J. Francyl & Mary B. Howard	Lot 5 Block 10 Rodgersdale	8,140.0	115.38
J. Francyl & Mary B. Howard	Lot 6 Block 10 Rodgersdale	8,140.0	115.39
J. Francyl & Mary B. Howard	Lot 7 Block 10 Rodgersdale	8,140.0	115.38
J. Francyl & Mary B. Howard	Lot 8 Block 10 Rodgersdale	8,140.0	115.39
J. Francyl & Mary B. Howard	Lot 9 Block 10 Rodgersdale	8,140.0	115.38
J. Francyl & Mary B. Howard	Lot 10 Block 10 Rodgersdale	8,140.0	115.39
Jack & Barbara Draper 1715 S. Hill Street	Lot 11 Block 10 Rodgersdale	8,140.0	115.38
Jack & Barbara Draper	Lot 12 Block 10 Rodgersdale	8,800.0	124.74
William R. Workman 2931 S. Main	Lot 4 Block 1 Ansley Park	6,566.77	93.09
William R. Workman	Lot 5 Block 1 Ansley Park	6,583.12	93.32
William R. Workman	Lot 6 Block 1 Ansley Park	6,627.96	93.95
William R. Workman	Lot 8 Block 2 Ansley Park	5,690.29	80.66
William R. Workman	Lot 9 Block 2 Ansley Park	5,440.38	77.12
William R. Workman	Lot 10 Block 2 Ansley Park	5,474.04	77.60
William R. Workman	Lot 11 Block 2 Ansley Park	5,507.70	78.07
William R. Workman	Lot 12 Block 2 Ansley Park	5,541.36	78.55
William R. Workman	Lot 13 Block 2 Ansley Park	5,575.02	79.03
William R. Workman	Lot 14 Block 2 Ansley Park	5,778.64	81.91
William R. Workman	Lot 5 Block 3 Ansley Park	6,104.03	86.52
William R. Workman	Lot 6 Block 3 Ansley Park	5,902.24	83.67
William R. Workman	Lot 7 Block 3 Ansley Park	5,944.42	84.26
William R. Workman	Lot 8 Block 3 Ansley Park	5,986.60	84.86
William R. Workman	Lot 1 Block 4 Ansley Park	7,600.0	107.73
William R. Workman	Lot 2 Block 4 Ansley Park	7,600.0	107.73
William R. Workman	Lot 3 Block 4 Ansley Park	7,634.0	108.21
William R. Workman	Lot 1 Block 5 Ansley Park	6,800.0	96.39
William R. Workman	Lot 2 Block 5 Ansley Park	6,600.0	93.56
William R. Workman	Lot 3 Block 5 Ansley Park	6,600.0	93.56
William R. Workman	Lot 4 Block 5 Ansley Park	6,600.0	93.56
William R. Workman	Lot 5 Block 5 Ansley Park	6,600.0	93.56
William R. Workman	Lot 6 Block 5 Ansley Park	6,600.0	93.56
William R. Workman	Lot 7 Block 5 Ansley Park	6,947.0	98.47
William R. Workman	Lot 1 Block 6 Ansley Park	7,400.0	104.89
William R. Workman	Lot 2 Block 6 Ansley Park	7,400.0	104.90
William R. Workman	Lot 3 Block 6 Ansley Park	7,400.0	104.90
William R. Workman	Lot 4 Block 6 Ansley Park	7,665.0	108.63

Name of Person
on Assessment Roll

Description
of Property

Area
Assessed

Amount of
Assessment

William R. Workman
2931 S. Main

An area bounded by Marion
St., R.R.St., 28th St.,
& a line 100' S. of the
S. boundary of 28th St.

19,166.0

\$ 271.68

Jack & Barbara Draper
1715 S. Hill Street

An area bounded by Marion
St., R.R.St., 28th St.,
& a line 75' N. of the N.
boundary of 28th St.

14,374.50

203.76

Section 3: The Recorder is hereby directed to enter a statement of the assessments as above prescribed in the docket of City Liens and give notice thereof as provided by law.

Passed by the Council: November 27, 1957

Approved by the Mayor: November 27, 1957

W. L. Lippert

Mayor

Effective Date: December 27, 1957

ATTEST:

Richard J. Gibson

City Recorder

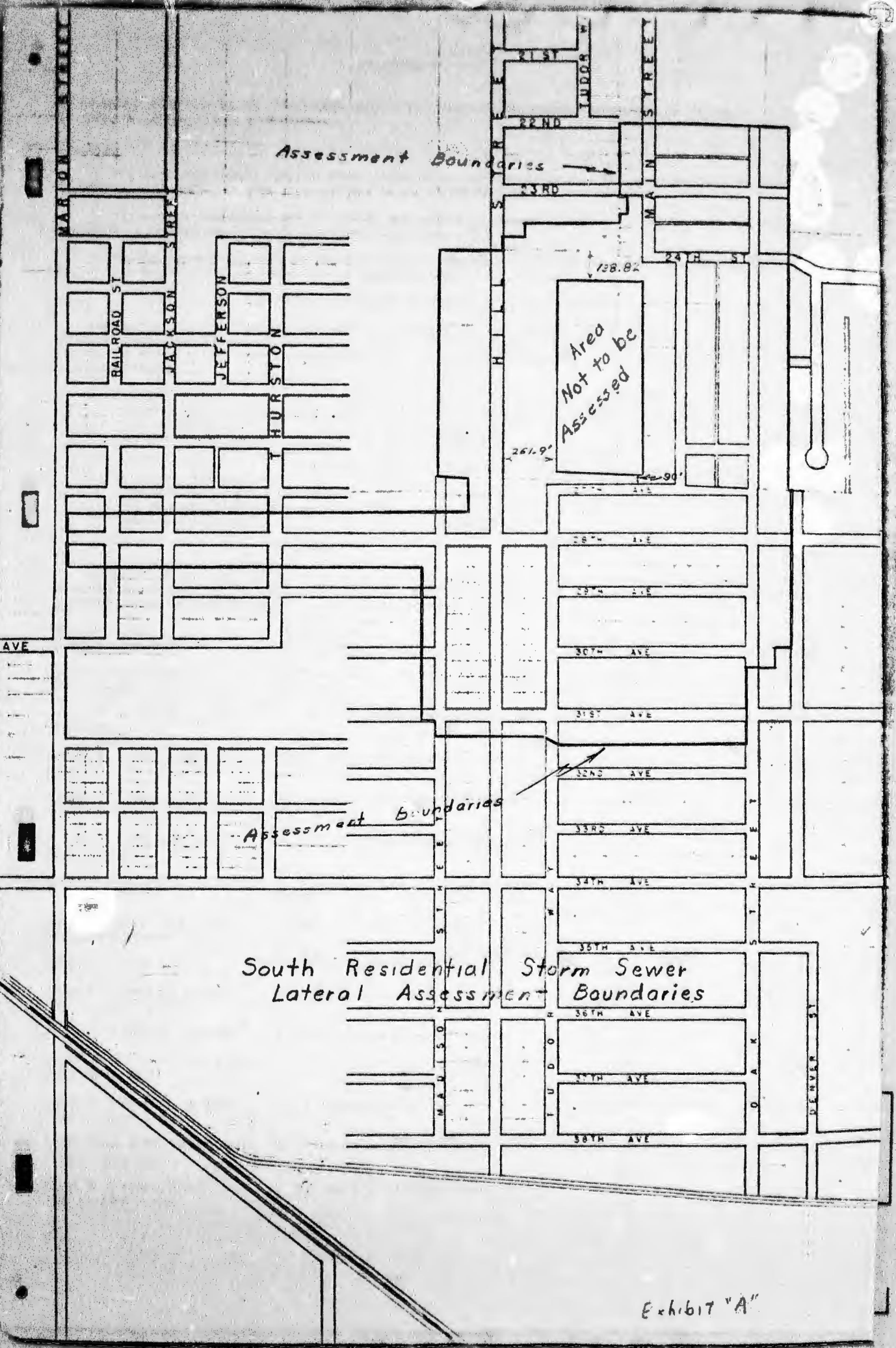

Assessment Boundaries

Area Not to be Assessed

Assessment Boundaries

South Residential Storm Sewer Lateral Assessment Boundaries